

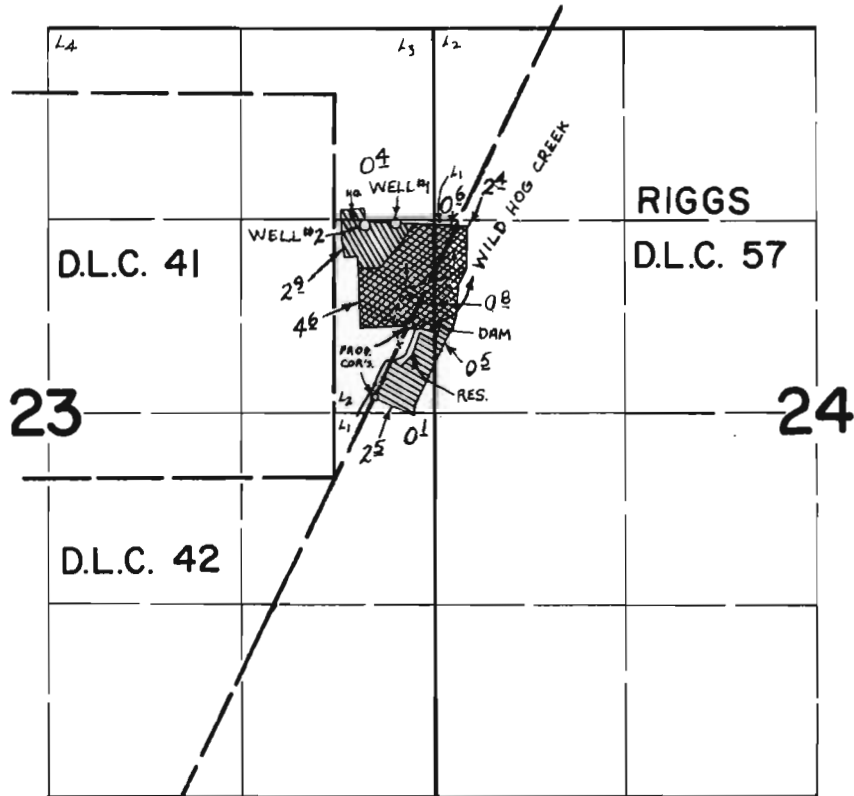



T.18S. R.3W. W.M.



DAM LOC.: 720'S. & 20'E. FROM NE COR LOT 2 SEC. 23.
 WELLS LOC.: #1- 30'S. & 260'W., #2- 40'S. & 480'W. BOTH FROM NE COR LOT 2 SEC. 23.

-  PRIMARY FROM WELLS
-  SUPPLEMENTAL FROM WELLS
-  PRIMARY FROM WILD HOG CR. - PERMIT # 35624

FINAL PROOF SURVEY

UNDER

Application No. G-5324 47582 Permit No. G-4939 35624

IN NAME OF

CECIL SAXON

Surveyed JULY 11 1975, by L. TOLL