

# T.11S., R.6W., W.M.

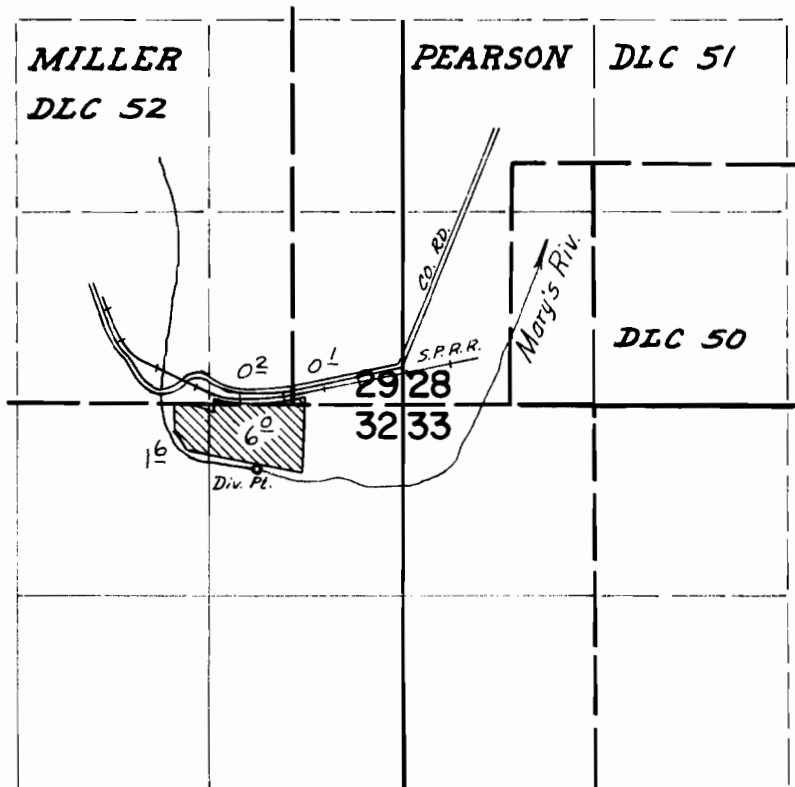

DIV. PT. LOC.: 440' S & 240' W FROM SE COR. MILLER DLC 52.

## FINAL PROOF SURVEY UNDER

Application No. 41462 Permit No. 30956  
IN NAME OF

PAUL FRANCE

Surveyed April 25, 1975, by D. Norby