

T. 13 S., R. 5 W., W.M.

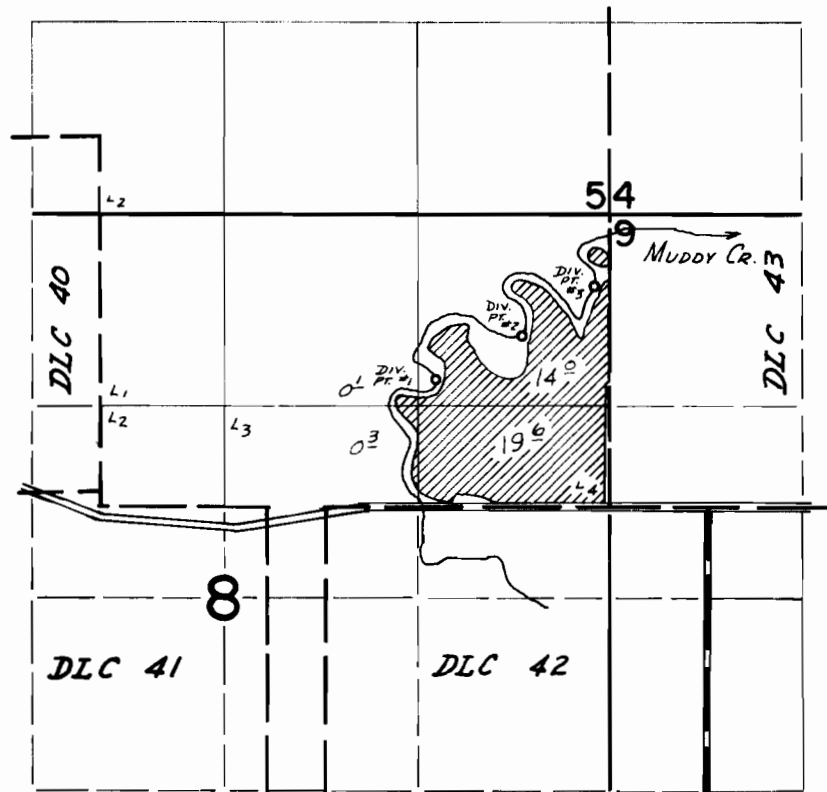

DIV. PTS. LOC.: 1- 860' N & 1190' W; 2- 1170' N & 600' W; 3- 1520' N & 100' W ALL FROM SE COR. LOT 4 SEC 8.

FINAL PROOF SURVEY
UNDER

Application No. 49034 Permit No. 36697
IN NAME OF

MELVIN J. STEPHENS

Surveyed April 21 1975, by D. Norby