

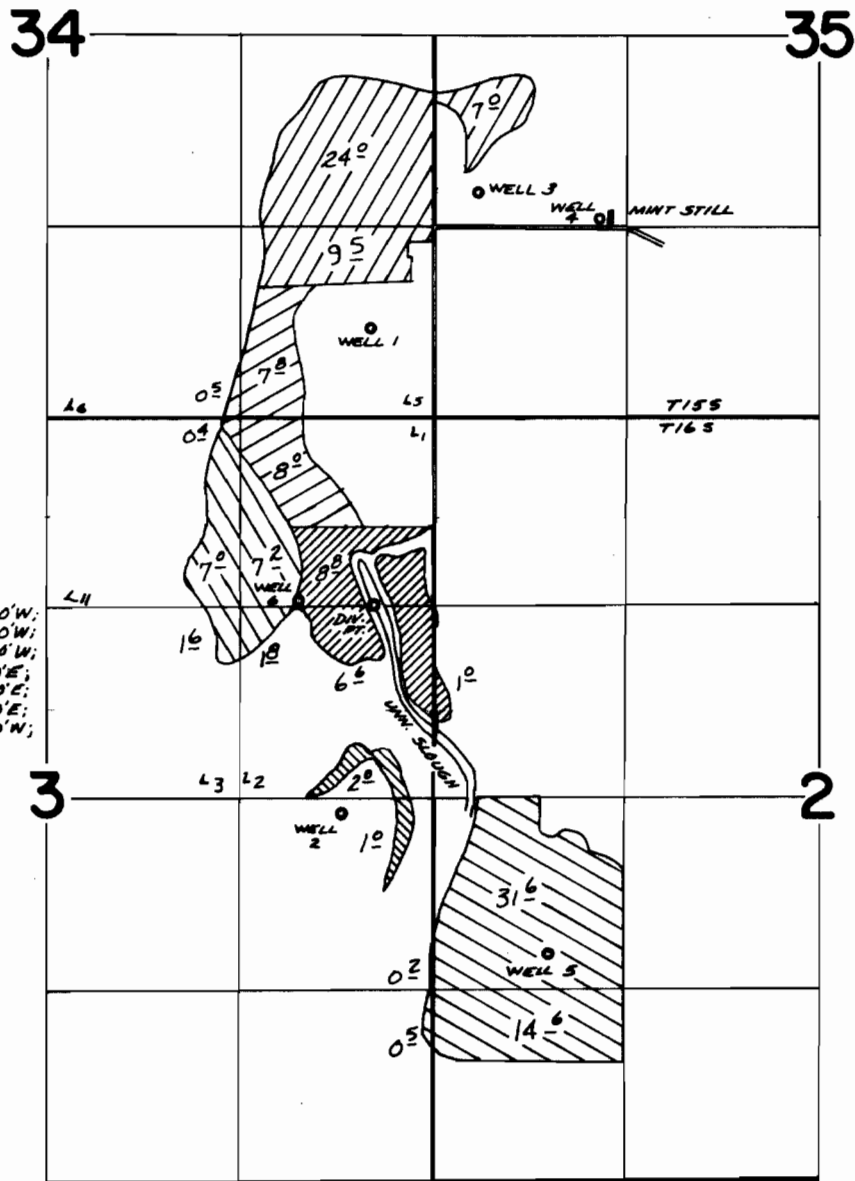





# T.15&16S., R.4W., W.M.

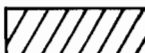

DIV. PT. LOCATED: 1290'S & 410'W;  
 WELLS LOCATED: 1-610'N & 430'W;  
 2-2780'S & 630'W;  
 3-1530'N & 300'E;  
 4-1350'N & 1120'E;  
 5-3680'S & 780'E;  
 6-1260'S & 920'W;  
 ALL FROM NE COR. SEC. 3.

-  Unn. Slough  
Per. 36152
-  Well No. 1  
Per. G-5011
-  Well No. 2  
Per. G-5012
-  Well No. 3  
Per. G-5013
-  Well No. 5  
Per. G-5015
-  Well No. 6  
Per. G-5016

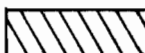
## FINAL PROOF SURVEY UNDER

Application No. 49043	G-5747	Permit No. 36152	G-5013
G-5745	G-5748	G-5011	G-5014
G-5746	G-5749	G-5012	G-5015
	G-5750		G-5016

IN NAME OF

**KENDALL S. AND SHARON K. SMITH**

Surveyed Aug. 7, 1974, by D.M. Norby