

T.2N. R.4W. W.M.

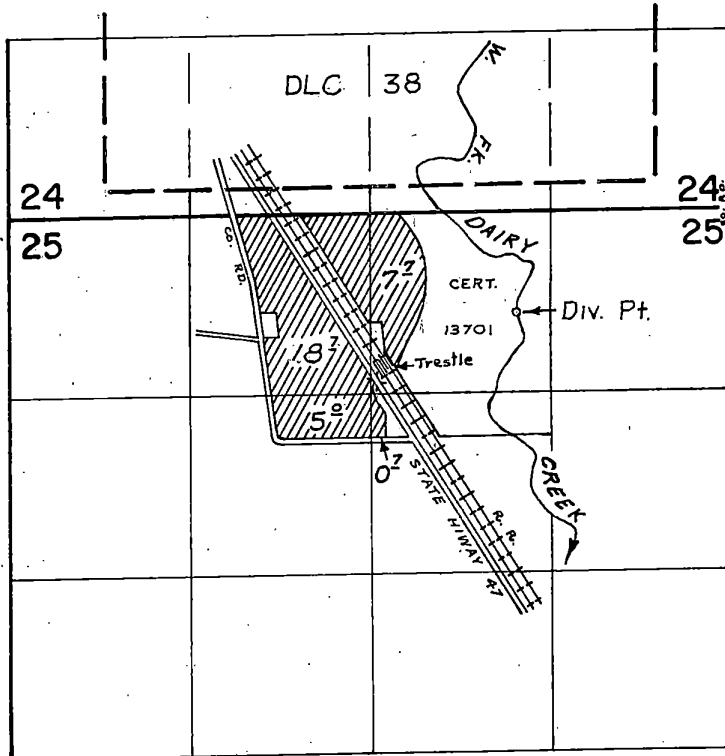

DIV. PT. LOC: 740' S. AND 1570' W. FROM N.E. COR. SECTION 25

FINAL PROOF SURVEY

UNDER
Transfer No. 2782
Application No. Permit No.

IN NAME OF
JOE EVERS

Surveyed Sept. 11, 1975, by R. Mucken