

T.15S., R.10E., W.M.

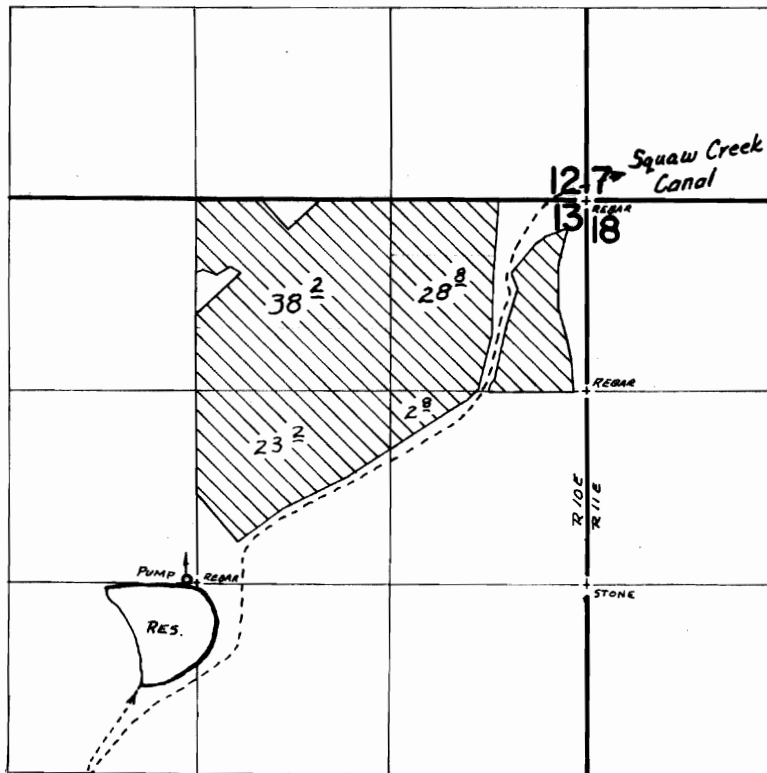

DIV. PTS. LOC: CR. - 1000' N & 1320' E FROM SW COR. SEC. 21
RES. - 20' N & 70' W FROM CENTER SEC 13

FINAL PROOF SURVEY UNDER

R-43129 R-4807
Application No. 43130 Permit No. 31702
IN NAME OF

KEITH CYRUS

Surveyed Oct. 29 1975, by D. Norby