

T.28S. R.4W. W.M.

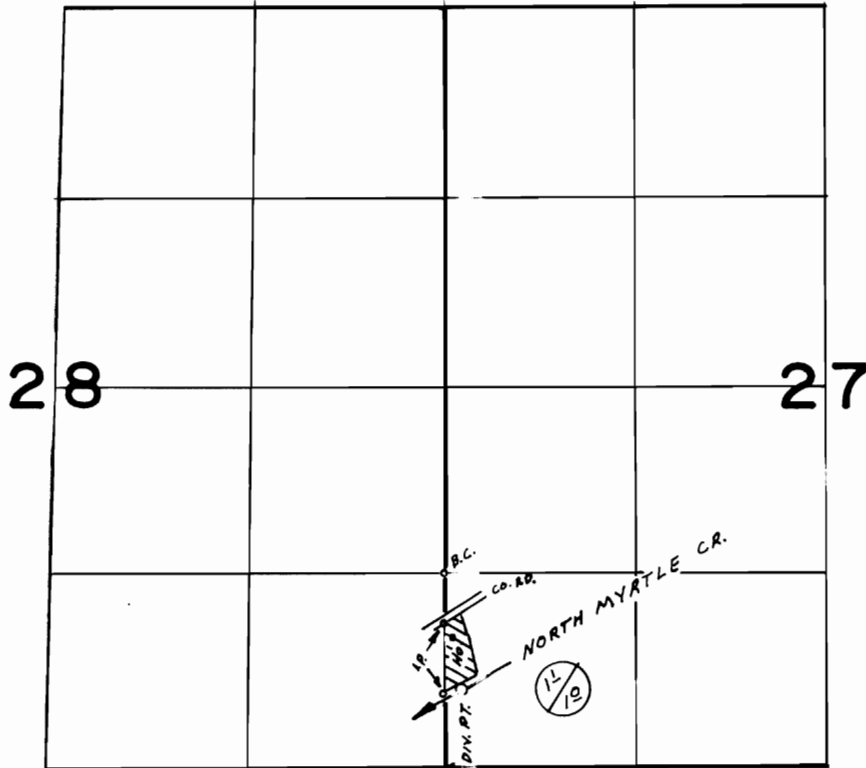

DIV. PT. LOC. 800'S. & 110'E. FROM NW COR. SW 1/4 SW 1/4 SEC. 27

PERMIT 36378
CERT. 3230

FINAL PROOF SURVEY
UNDER

Transfer No. 4611
Application No. 48470... Permit No. 36378...
IN NAME OF

.....**JOHN W. KELLER**.....

Surveyed MAR. 28 1975, by L.H. NUNN.....
Aug. 18 1981 by L. TOLL