

T.31S.,R.2W.,W.M.

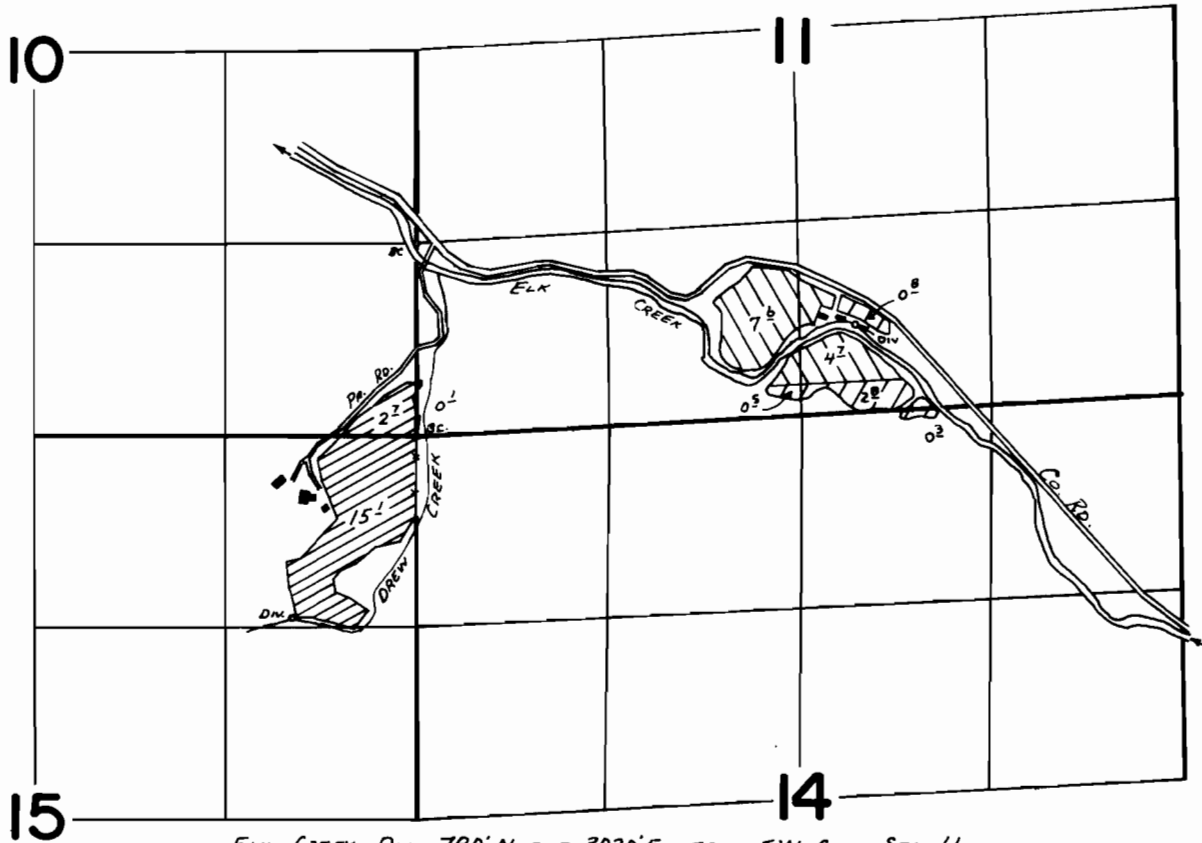

ELK CREEK DIV. - 780' N AND 3020' E FROM SW COR. SEC. 11
 DREW CREEK DIV. - 1250' S AND 850' W FROM NE COR. SEC. 15

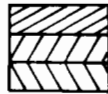

- DREW CREEK IRRIGATION (PERMIT 35115)
- ELK CREEK IRRIGATION (PERMIT 35115)
- ELK CREEK IRRIGATION (PERMIT 40224)

FINAL PROOF SURVEY UNDER

Application No. 46961 Permit No. 35115
53911 40224
 IN NAME OF

ROBERT E. & KAY C. OSLAR

Surveyed MAY 20 1975, by L. TOLL