

T.25S. R.30E. W.M.

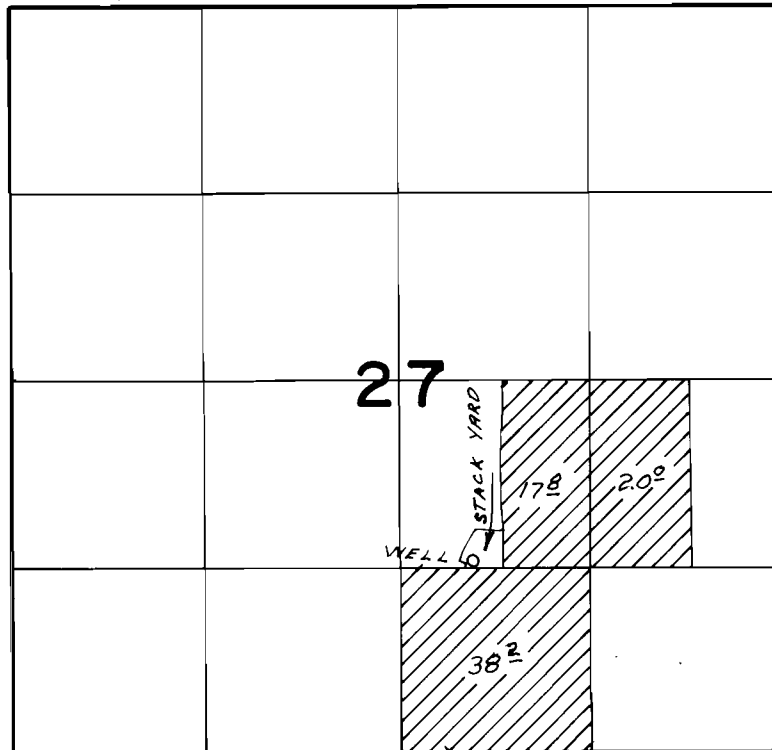

WELL LOC. 1230'S. & 510'E. FROM CENTER SEC. 27

FINAL PROOF SURVEY
UNDER

Application No. G-4279 Permit No. G-4028
IN NAME OF

.....JAMES E. DUNN.....

Surveyed JULY 25, 1975, by L.H. NUNN.....