

# T.1S. R.2&3W. W.M.

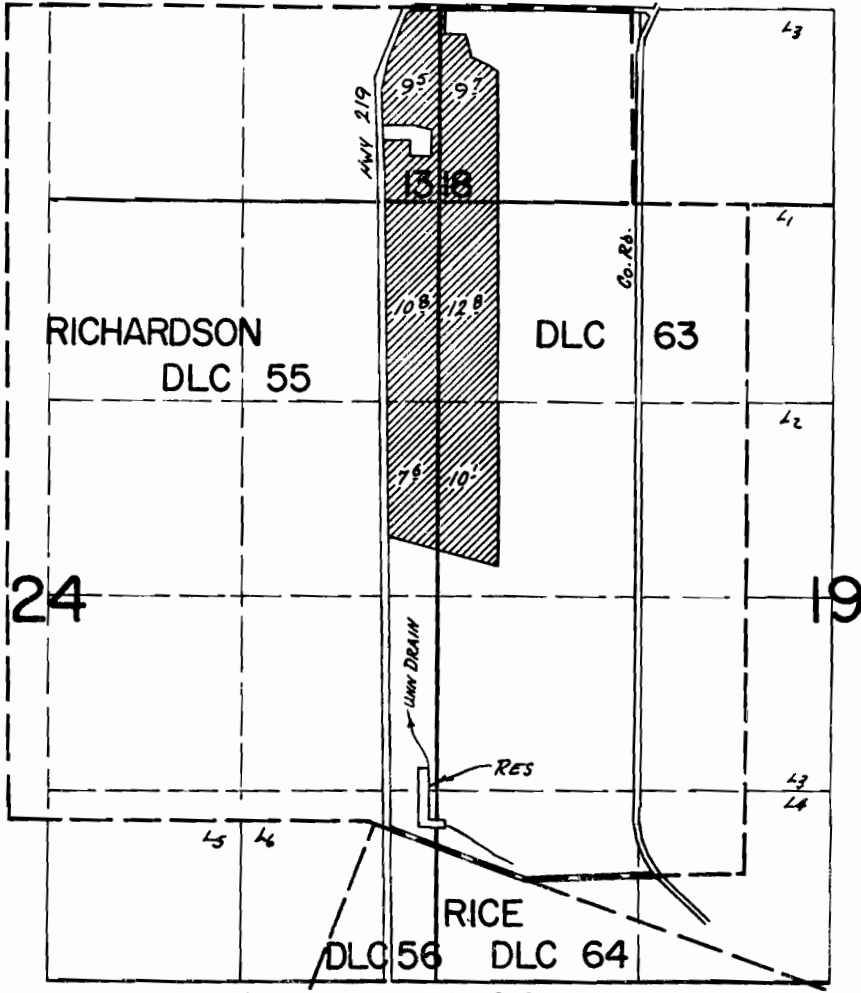

RES LOC 150' N + 340' E FROM NW COR RICE DLC 56

## FINAL PROOF SURVEY UNDER

R-44113                      R-5091  
Application No. ~~44114~~ Permit No. ~~32952~~  
IN NAME OF

.....THOMAS E. WITHYCOMBE.....

Surveyed July 1, 1974, by R. G. MUCKEN