

T.26S., R.11W., W.M.

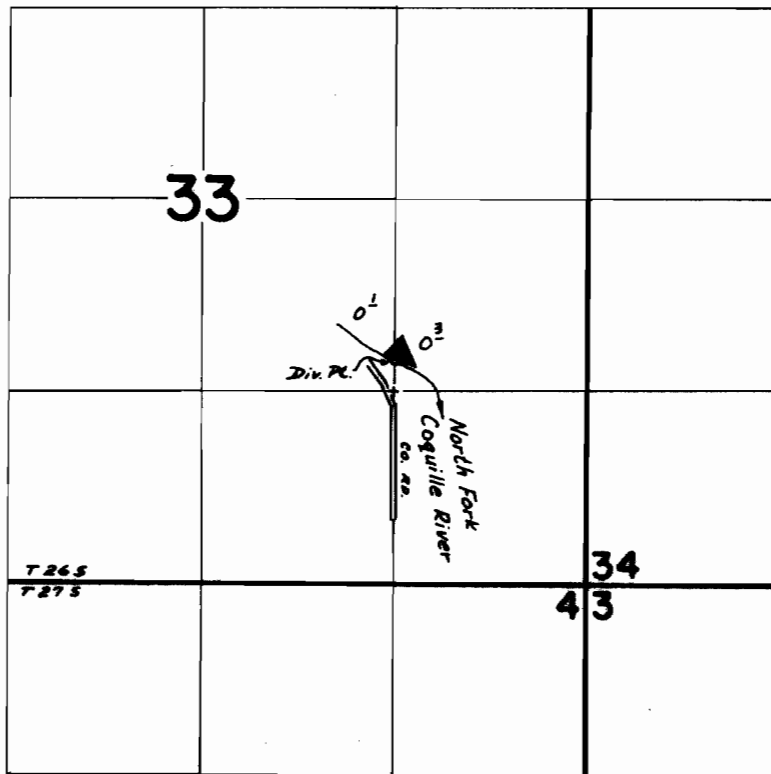

DIV. PT. LOC: 210' N FROM SW COR NE  $\frac{1}{4}$  SE  $\frac{1}{4}$  SEC. 33.

**FINAL PROOF SURVEY**  
UNDER

Application No. 52083 Permit No. 37478  
IN NAME OF

BENTON FLAXEL

Surveyed Sept. 23 1975, by D. Norby