

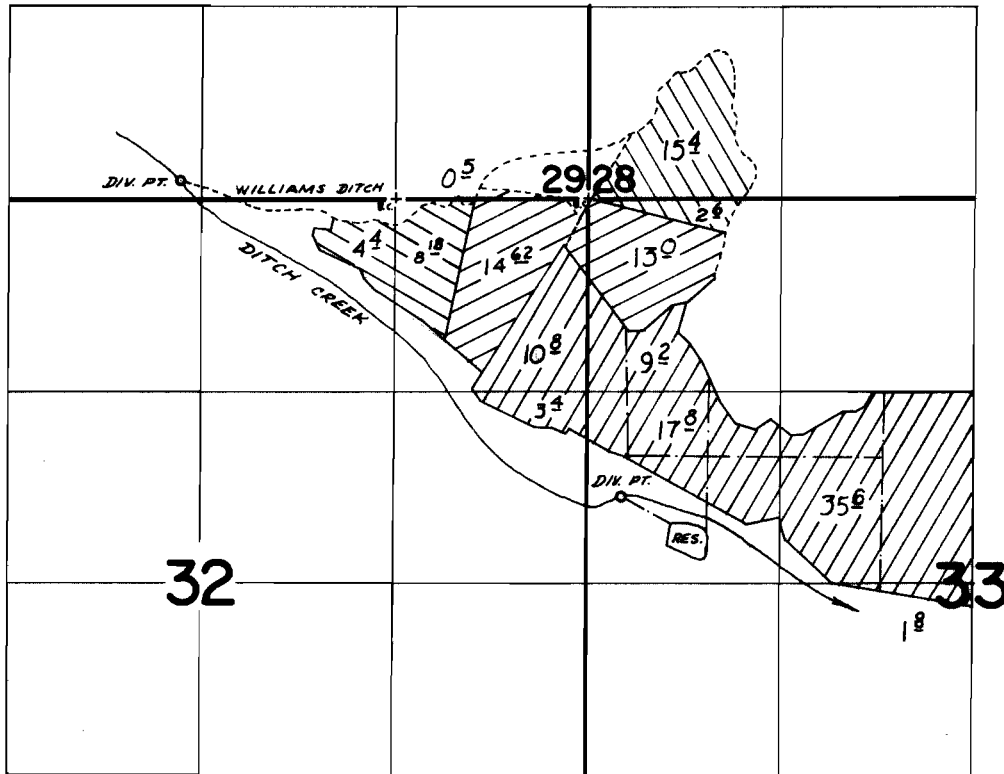



T.34S., R.4W., W.M.

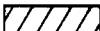
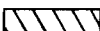

DIV. PTS. LOC: N'LY- 125' N & 140' W FROM S $\frac{1}{4}$ COR SEC. 29; S'LY- 2040' S & 230' E;
RES. - 2290' S & 820' E BOTH FROM NW COR. SEC. 33

-  T-2469, VIA WILLIAMS DITCH
-  T-2469, FROM RES.
A-46480, FROM RES.
-  T-2470, VIA WILLIAMS DITCH
-  T-2471, VIA WILLIAMS DITCH

FINAL PROOF SURVEY UNDER

Transfer No. 2469, 2470 & 2471
R-46479 R-5541
Application No. 46480 Permit No. 34738
IN NAME OF

DITCH CREEK RANCH

Surveyed May 8 1975, by D. Norby