

T.17S. R.6W. W.M.

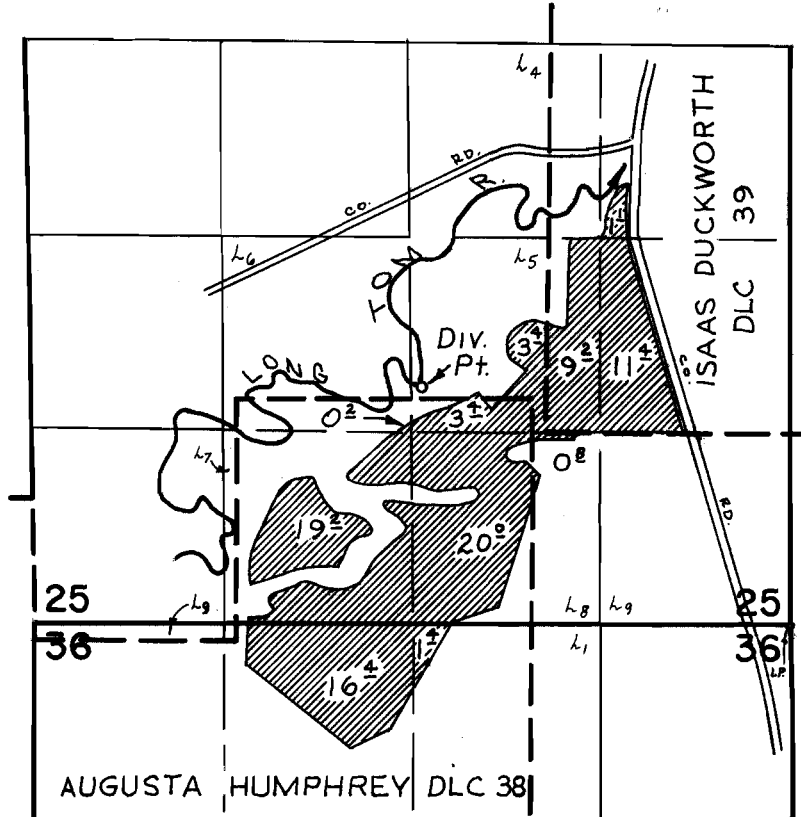

DIV. PT. LOC.: 1620' N. AND 2520' W. FROM S.E. CORNER SECTION 25

FINAL PROOF SURVEY UNDER

Application No. 40362 Permit No. 30093
IN NAME OF

BERNARD ARVID LARSON

Surveyed May 1, 1975, by R. Mucken