

T. 1 N. R. 1 W. W. M.

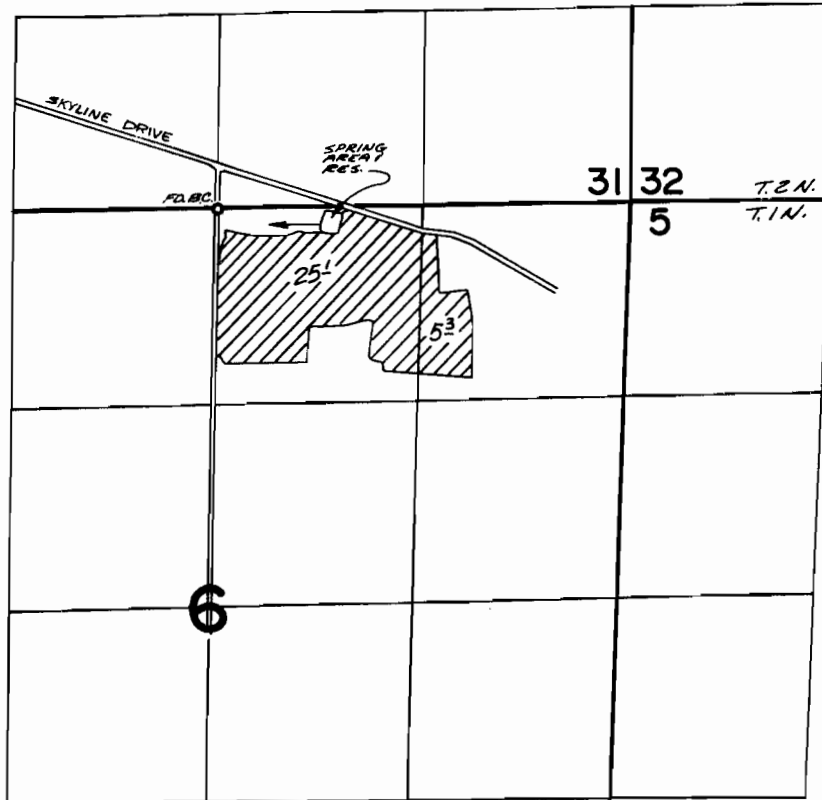

DIV. PT. LOCATED 100' S. & 700' E. FROM N. 1/4 COR. SEC. 6

FINAL PROOF SURVEY UNDER

R 45992 R 5469
Application No. 45780 Permit No. 34283
IN NAME OF

TED & DON MOTZ

Surveyed JULY 9 1975, by R.G. MUCKEN