

T.34S. R.1W. W.M.

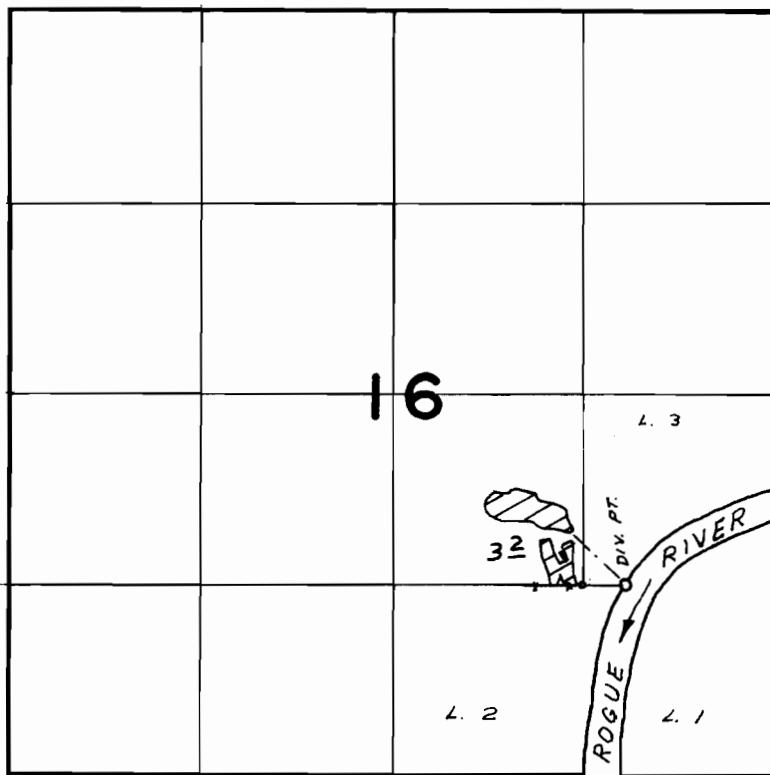

DIV. PT. LOC. 300' E. FROM SW COR. LOT 3

FINAL PROOF SURVEY UNDER

Application No. 44244... Permit No. 33048...
IN NAME OF

..... GEORGE T. MASON

Surveyed APR. 29 1975, by L.H. NUNN.....