

# T.6N.R.35E.W.M.

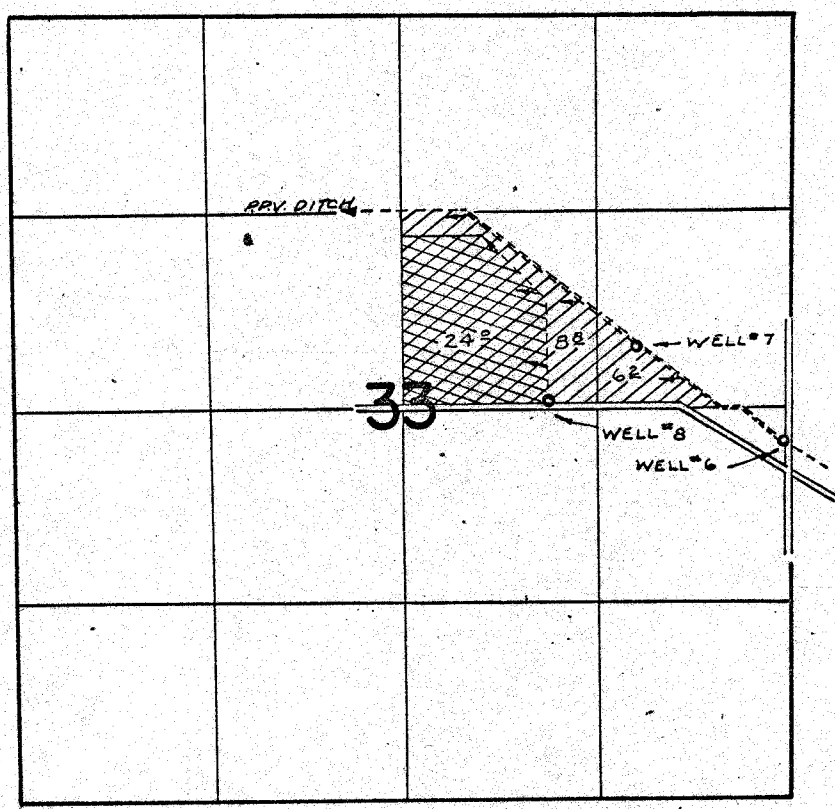

WELLS LOC: #6 - 280'S & 30'W; #7 - 420'N & 1040'W; #8 - 30'N & 1650'W, ALL FROM E 1/4 COR. SEC 33

## FINAL PROOF SURVEY UNDER

Application No. G-5861 Permit No. G-4998 → [diagonal hatching symbol]  
G-5862 Permit No. G-4999 → [diagonal hatching symbol]  
G-5863 Permit No. G-5222 → [diagonal hatching symbol]

IN NAME OF

WILLIAM J. JACKSON

Surveyed APR. 11, 1973, by R. MUCKEN