

# T. 37S. R. 1W. W.M.

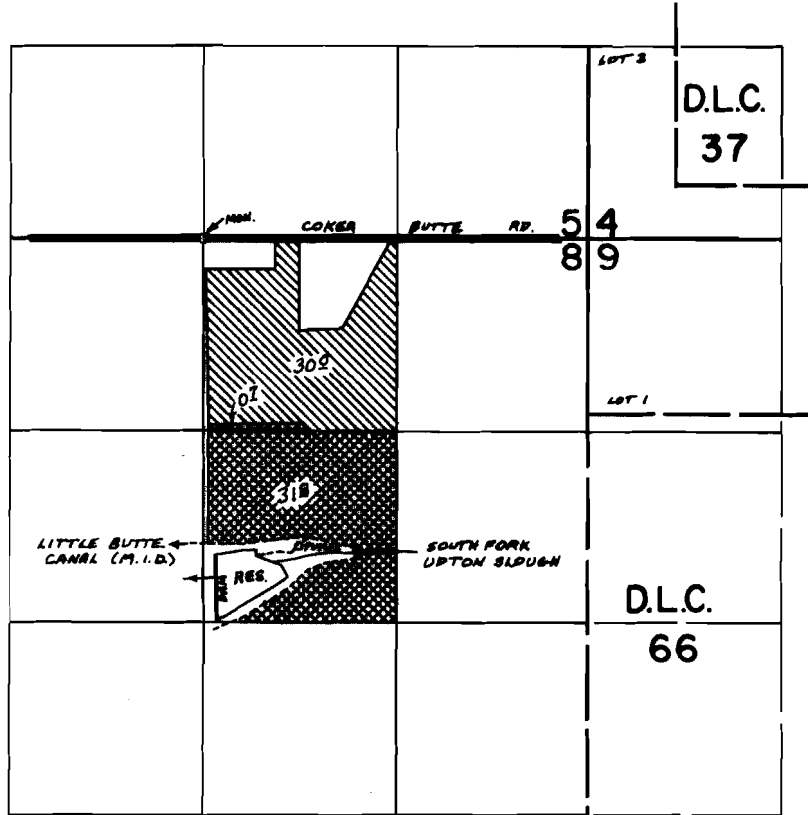

DAM LOC.: 2330'S. & 90'E. FROM N 1/4 COR SEC 8  
 CANAL DIV. PT. (FROM S. FORK LITTLE BUTTE CR.) LOC.: 600'S. & 525'W. FROM  
 E 1/4 COR SEC 29, T. 36S., R. 2E., W.M.

- TEMPERATURE CONTROL FROM S. FORK LITTLE BUTTE CR. AND S. FORK UPTON SLOUGH
- SUPPLEMENTAL IRRIGATION FROM S. FORK UPTON SLOUGH

## FINAL PROOF SURVEY UNDER

R-45725                      R-5420  
 45726                      34121  
 Application No. .... 47122. Permit No. .... 35285.  
 IN NAME OF

DUNBAR CARPENTER

Surveyed NOV. 3 1975, by L. I. Q. L.