

T.34S. R.7 W. W.M.

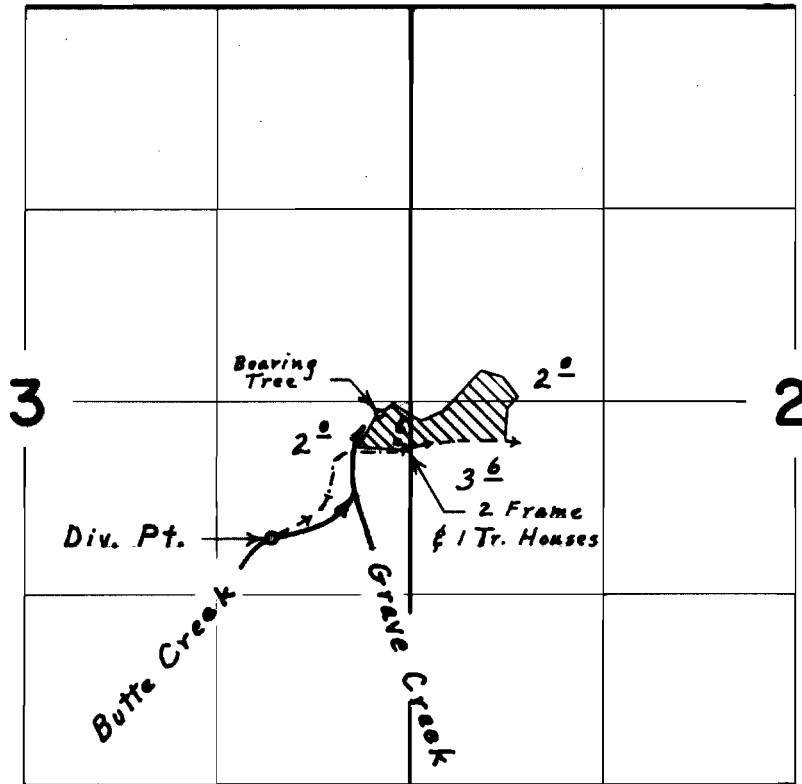

Div. Pt. loc. 930' S. & 940' W. from East $\frac{1}{4}$ Corner Section 3

FINAL PROOF SURVEY
UNDER

Application No. 46358 Permit No. 35127
IN NAME OF

MARY E. GRAY

Surveyed April 8, 1975, by L. E. Gould