

# T.39S. R.20E. W.M.

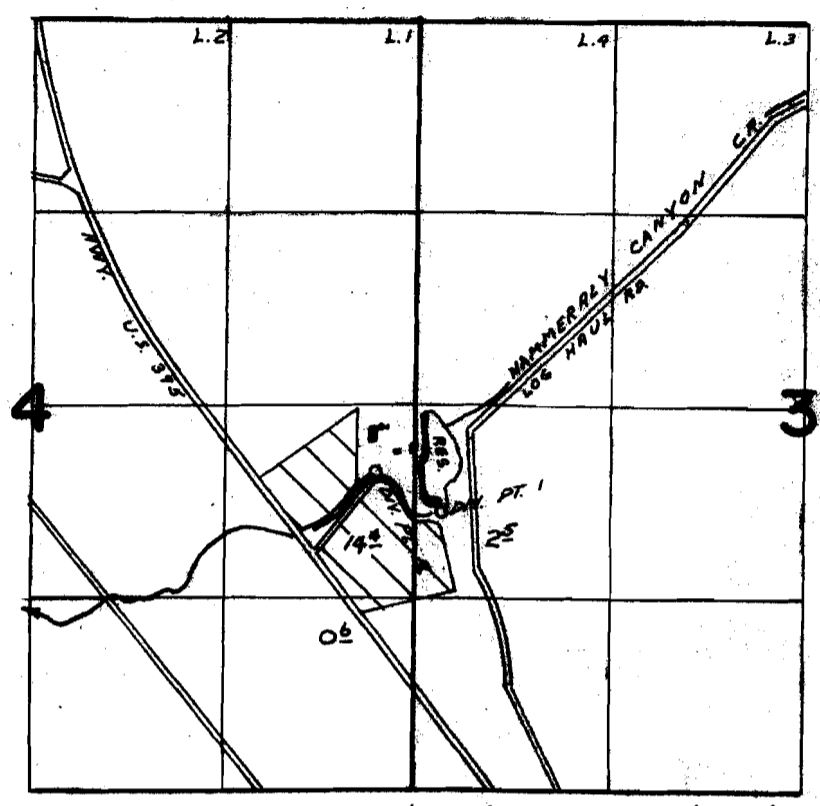

DIV. PTS. LOC., 1- 730'S & 210'E, 2- 460'S & 260'W,  
BOTH FROM THE W 1/4 COR. SEC. 3

## FINAL PROOF SURVEY UNDER

Application No. 44711 Permit No. 33475  
IN NAME OF

JIM SNIDER

Surveyed JUL 9 1975, by L.H. NUNN