

T. 6 N. R. 38 E. W.M.

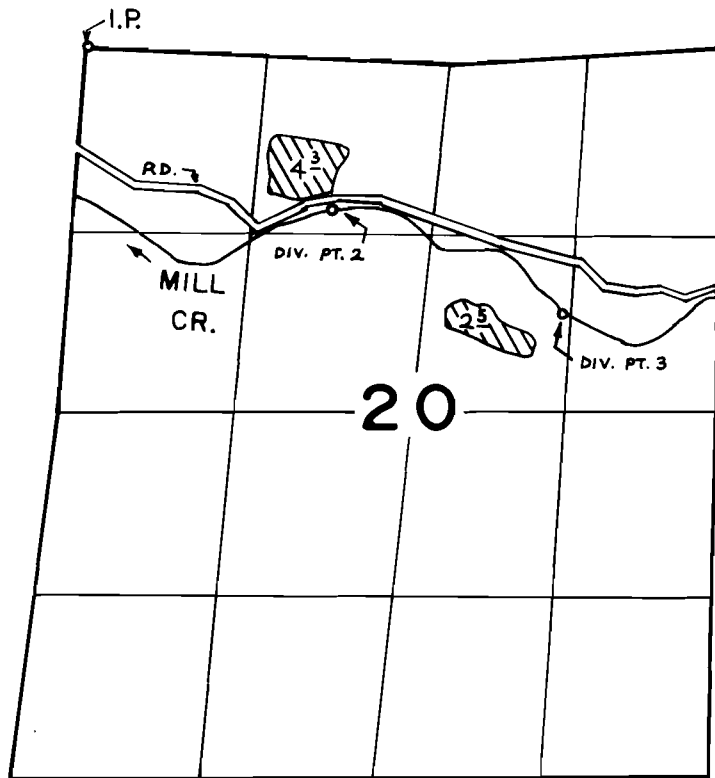

DIV. # 2 LOC. - 1120' S. & 1660' E., # 3 - 1850' S. & 3240' E. BOTH
FROM N.W. COR. SEC. 20

FINAL PROOF SURVEY UNDER

Application No. 40680 Permit No. 30525
IN NAME OF
KLICHER BROS.

Surveyed April 8, 1975, by L. H. Nunn