

T# 2836

# T.2N. R.11E. W.M.

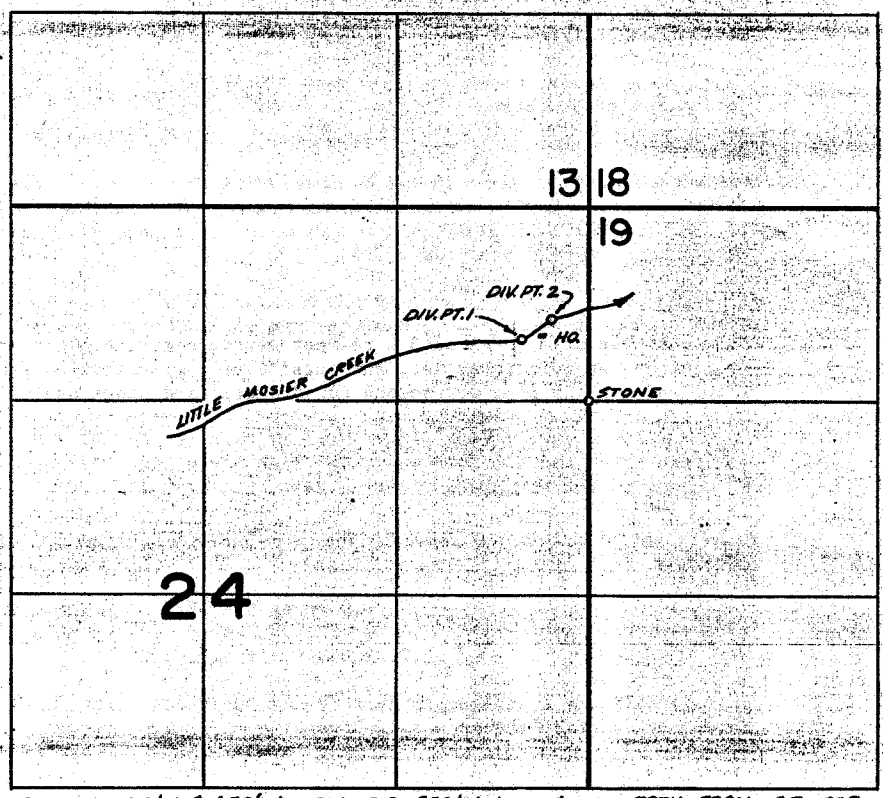

DIV. PT. 1, 420' N. & 450' W., DIV. PT. 2, 550' N. & 270' W., BOTH FROM SE. COR. N.E. 1/4 N.E. 1/4 SEC. 24

## FINAL PROOF SURVEY UNDER

TRANSFER No. 2836  
 Application No. .... Permit No. ....  
 IN NAME OF  
**L. G. BECK**

Surveyed **JUNE 3, 1975** by **R.G. MUCKEN**  
**JUNE 28, 1977** **R.G. MUCKEN**