

# T.2N. R.4W. W.M.

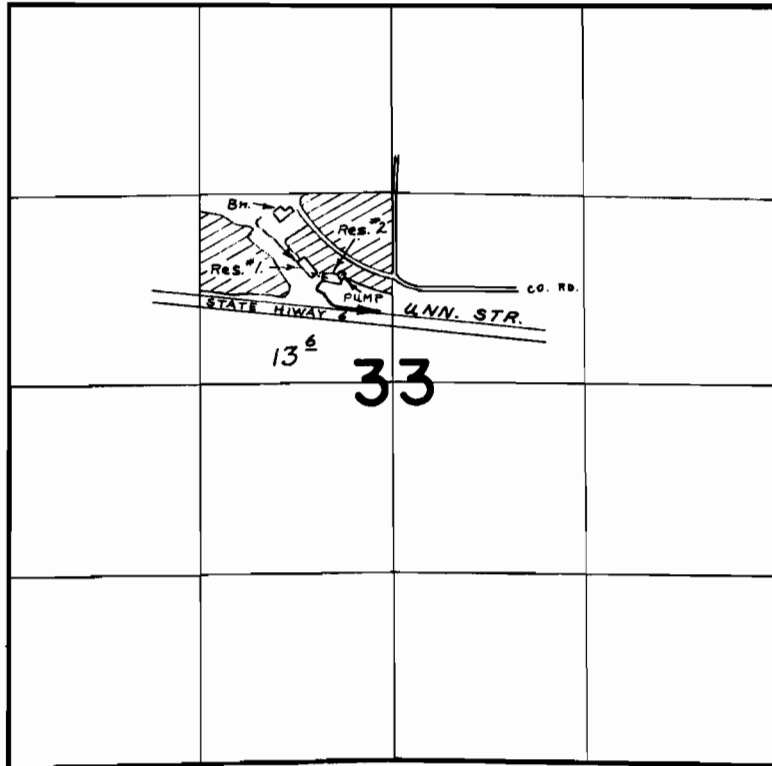

DIV. PT. FOR BOTH RES'S. LOC: 740' N. & 530' W. FROM  
CENTER SECTION 33

## FINAL PROOF SURVEY

R-42023

R-4810

42024

31709

R-44891

R-5302

Application No. 44892 Permit No. 33565

IN NAME OF

OLIVER J. JOHANSON

Surveyed Sept. 12, 1975, by R. Mucken