

T.18&2N. R.3W. W.M.

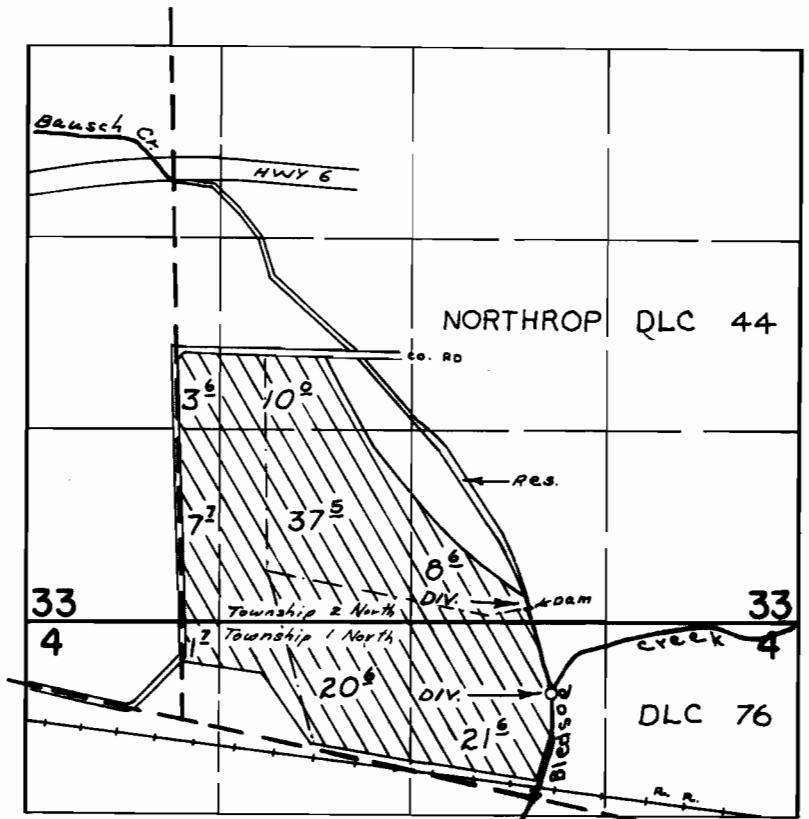

DIV. PTS. LOC: BLEDSOE CR. - 180' N. AND 2520' E., BAUSCH CR. DAM - 760' N. AND 2360' E., BOTH FROM SW COR. NORTHROP DLC 76

FINAL PROOF SURVEY
UNDER

R-46130 R-5492
Application No. 46131 Permit No. 34502
IN NAME OF

ERNEST BEHRMAN

Surveyed Sept. 8, 1975, by R. Mucken