

T.1N. R.3W. W.M.

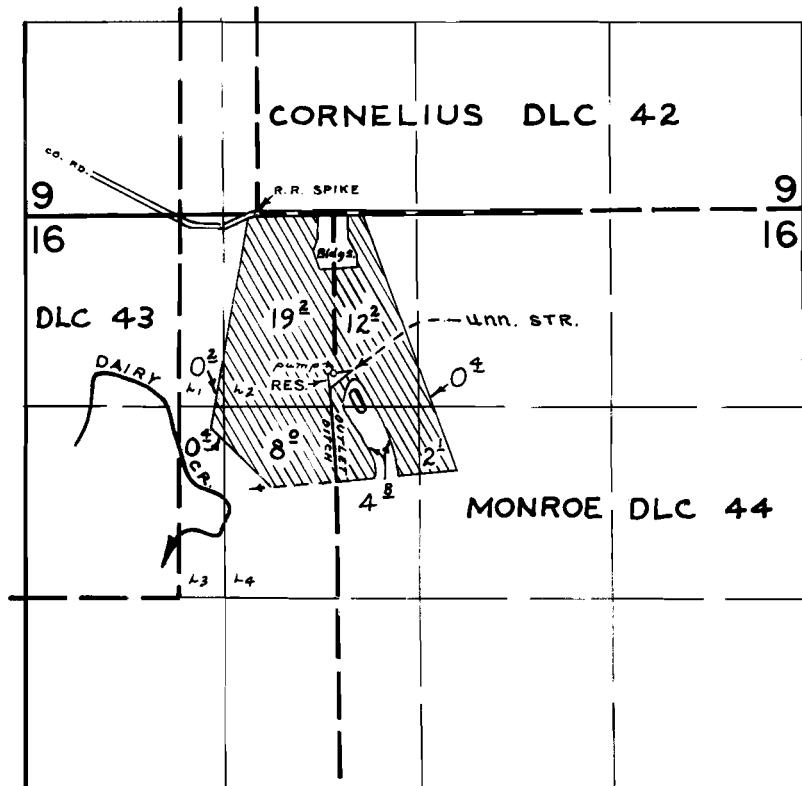

RES. LOC: 1040' S. AND 540' E. FROM S.W. COR. CORNELIUS DLC 42

FINAL PROOF SURVEY UNDER

R-47904 R-5797
 Application No. 48089 Permit No. 35913
 IN NAME OF

DAVID F. DELPLANCHE

Surveyed August 7, 1975, by R. Mucken