

G-5163

44901

T.6N. R.36E. W.M.

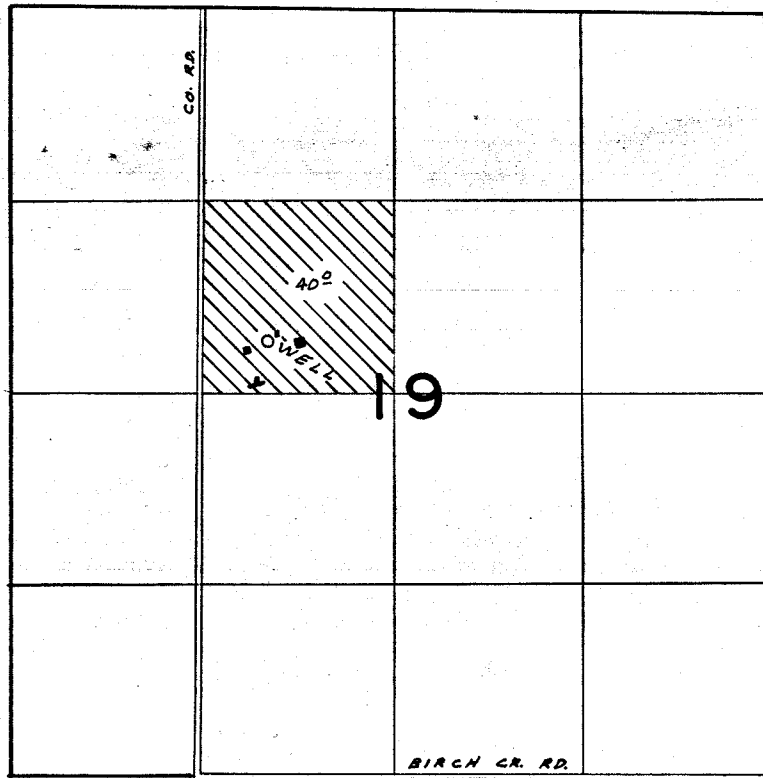

WELL LOC. 350' N. & 870' W. FROM CENTER SEC. 19

FINAL PROOF SURVEY UNDER

Application No. G-6098... Permit No. G-5163...
IN NAME OF

J.R. BAILEY

Surveyed APR. 4... 1975., by L.H. NUNN.....