

T. 4 N., R. 29 E., W.M.

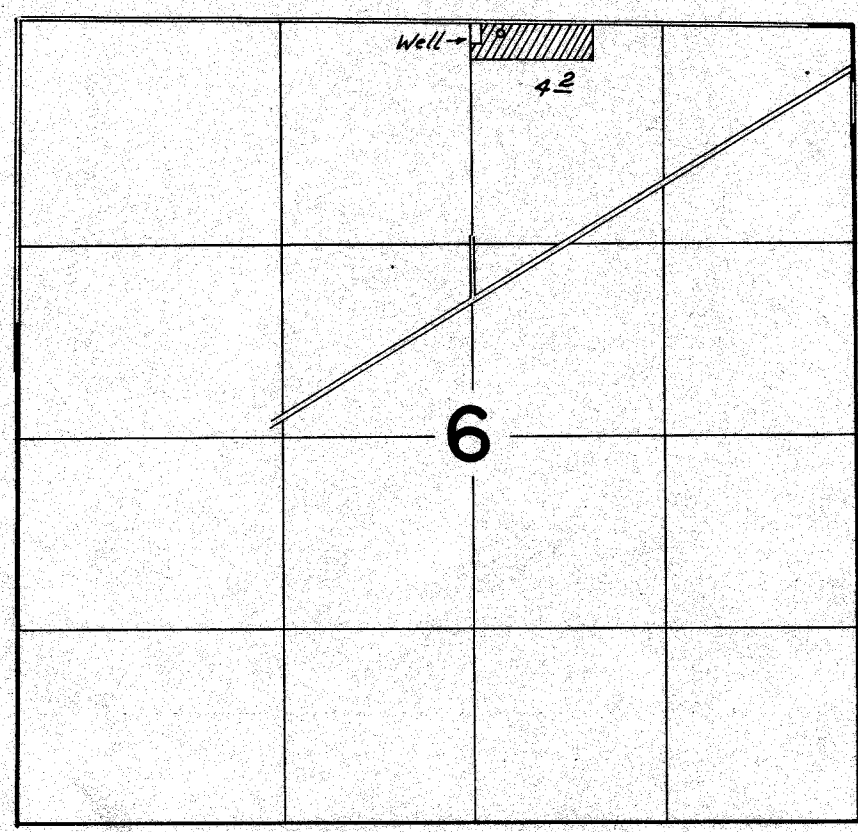

Well Loc.: 80 ft. S. & 200 ft. E. from N. 1/4 Cor. Sec. 6

FINAL PROOF SURVEY UNDER

Application No. G-6133 Permit No. G-5803
IN NAME OF

Delbert Kerns

Surveyed July 24, 1976 by L.H. Nunn