

# T.6S.,R.6&7W.,W.M.

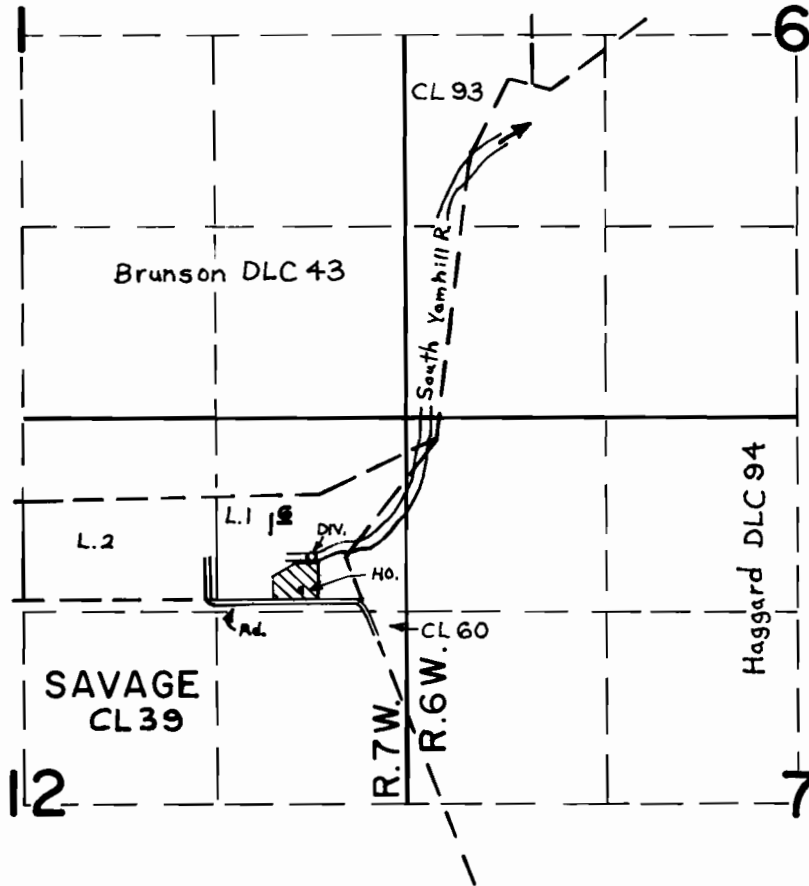

DIV. LOC. - 310' N. & 340' W. FROM N.E. COR. SAVAGE D.L.C. 39

## FINAL PROOF SURVEY UNDER

Application No. 52986... Permit No. 37830...  
IN NAME OF

**RAYMOND R. & MARY J. RODGERS**

Surveyed June 4, 1976, by R.G. Mucken...