

# T.3N. R.29E. W.M.

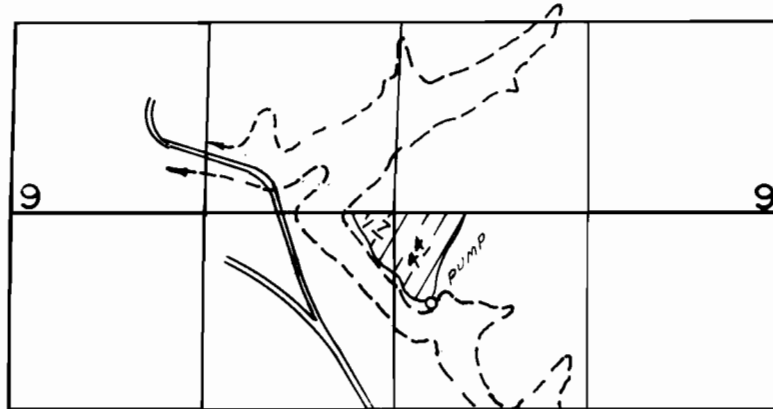

## T.3N. R.29 & 30E. W.M.

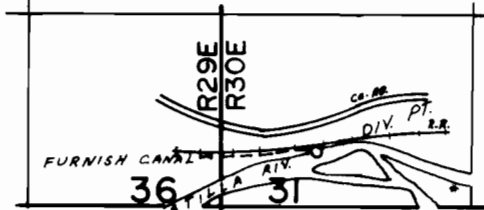

DIV. PT. LOC. 380' N. & 650' E. FROM SW COR. SEC. 31

16

FURNISH CANAL  
U.S. FEED CANAL

## FINAL PROOF SURVEY UNDER

Application No. 51943... Permit No. 37406...  
IN NAME OF

ECHO CEMETERY DISTRICT

Surveyed SEP. 10. 1975., by L.H. NUNN