

T.18S. R.8W. W.M.

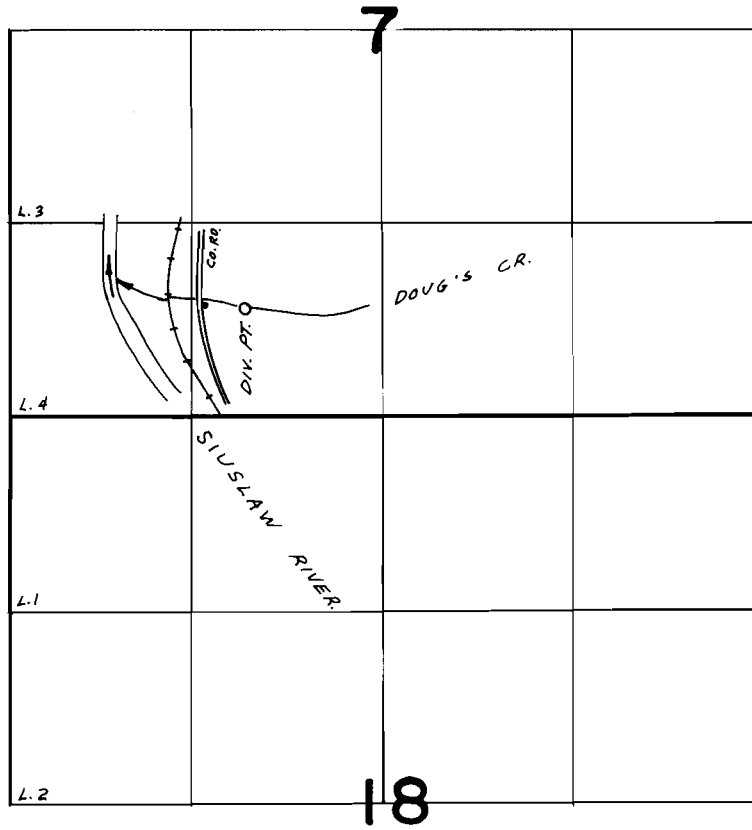

DIV. PT. LOC. 740' N. & 1610' E. FROM SW COR. SEC. 7

FINAL PROOF SURVEY
UNDER

Application No. 48429 Permit No. 36354
IN NAME OF

Leslie R. & Helen M. Green

Surveyed MAY 5 1976, by L.H. NUNN