

T. 2S. R. 44E. W.M.

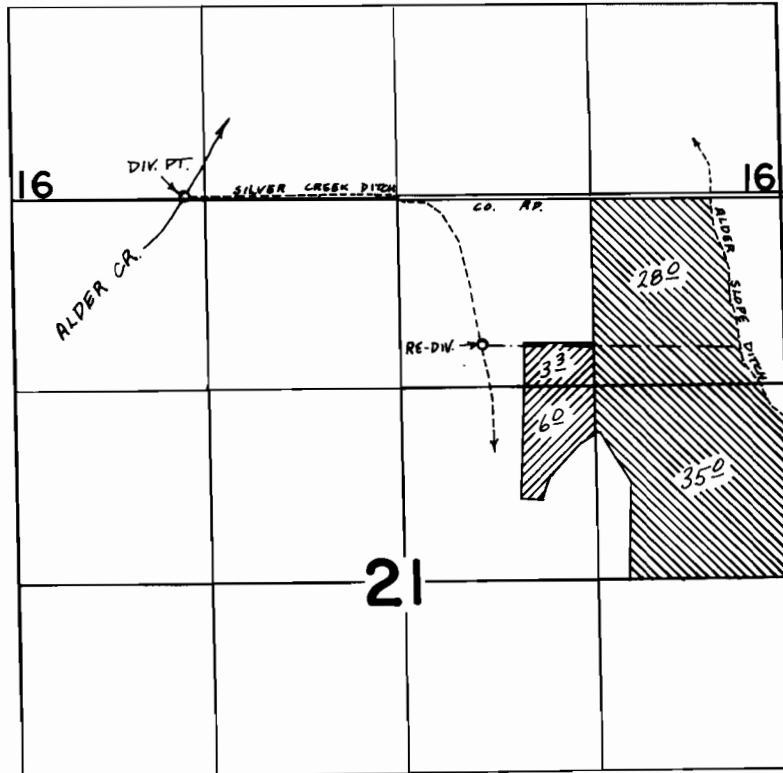

DIV. PT. LOC.: 10' N. & 1460' W. FROM N 1/4 COR. SEC. 21

-  PRIMARY IRRIGATION
-  SUPPLEMENTAL IRRIGATION

FINAL PROOF SURVEY UNDER

Application No. 49942 Permit No. 37565
IN NAME OF

CARL M. BAXTER

Surveyed OCT. 31 1975, by L. H. NUNN