

T.1N., R.4&5W., W.M.

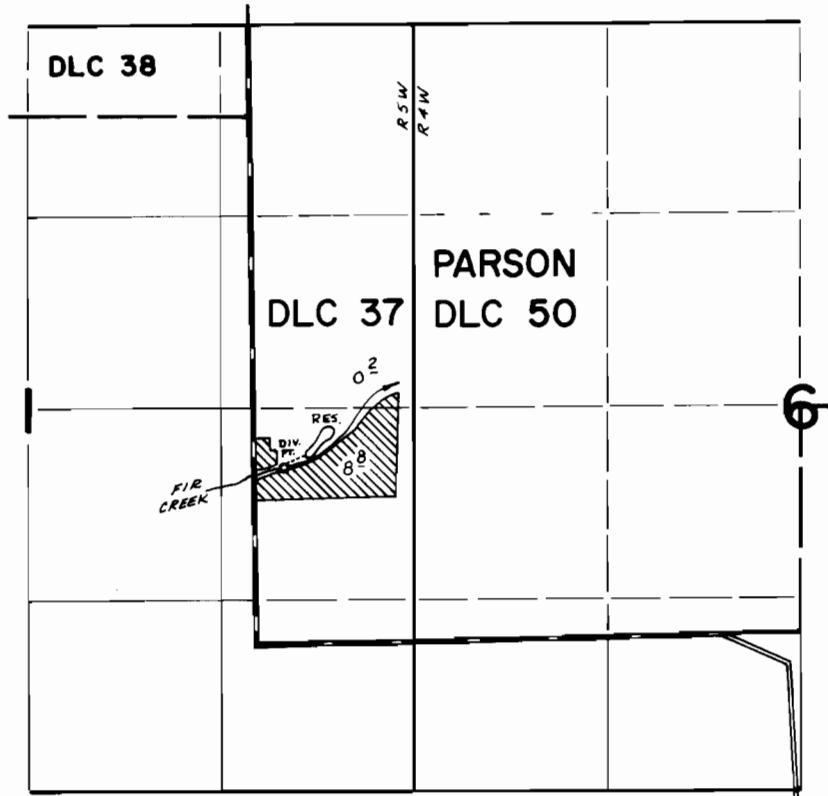

DIV. PTS. LOC: CR - 1200' N & 210' E; RES - 1380' N & 430' E FROM SW COR PARSON DLC 50

FINAL PROOF SURVEY UNDER

R-45232 R-5340
Application No. 45403 Permit No. 33840
IN NAME OF

RODNEY L. WANLESS

Surveyed Oct. 7, 1975, by D. Norby