

T. 4 S. R. 1 W. & 1 E. W. M.

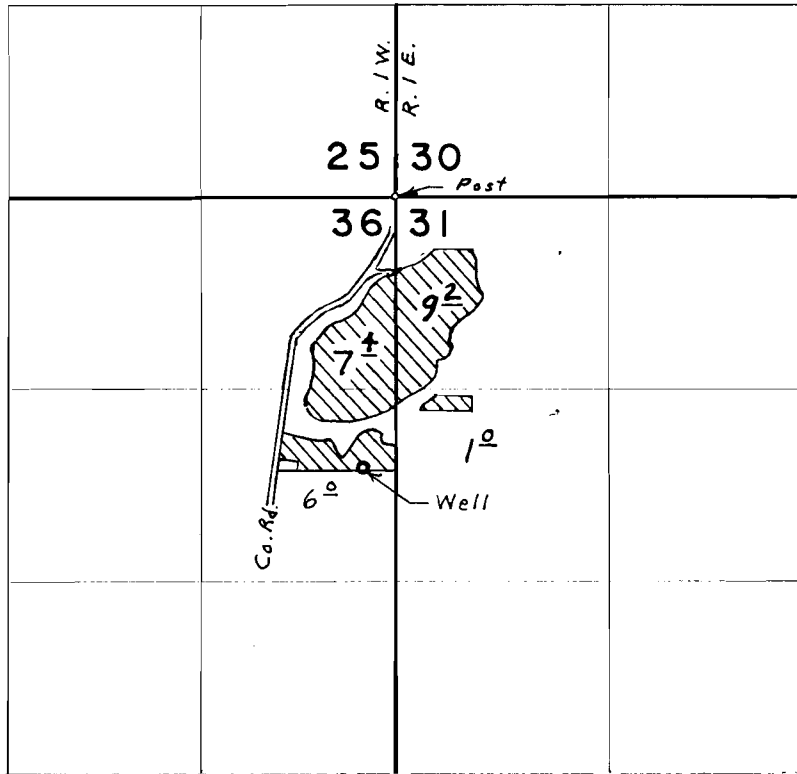

Well located; 1870' S. & 220' W. from N. E. Cor. Sec. 36

FINAL PROOF SURVEY UNDER

Application No. G-5471 Permit No. G-5379
IN NAME OF

LLOYD JOHNSTON

Surveyed Mar. 29, 1976, by L. E. Gould