

T.21S.,R.11W.,W.M.

NW 1/4 NW 1/4 SEC 16

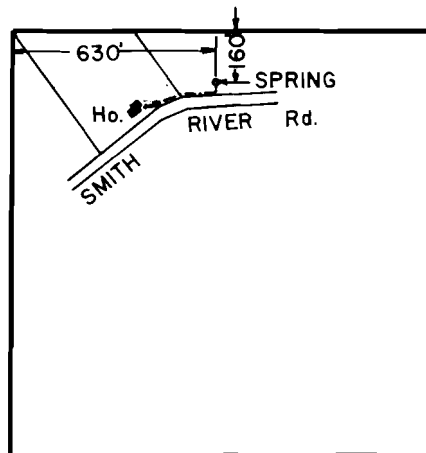

SCALE: 1" = 600'

**FINAL PROOF SURVEY**  
UNDER

Application No. 52177 Permit No. 39288  
IN NAME OF

STEPHEN CLARENCE LOVEALL

Surveyed MAY 24 1976, by L. T. L.