

T.28&29S. R.8W. W.M.

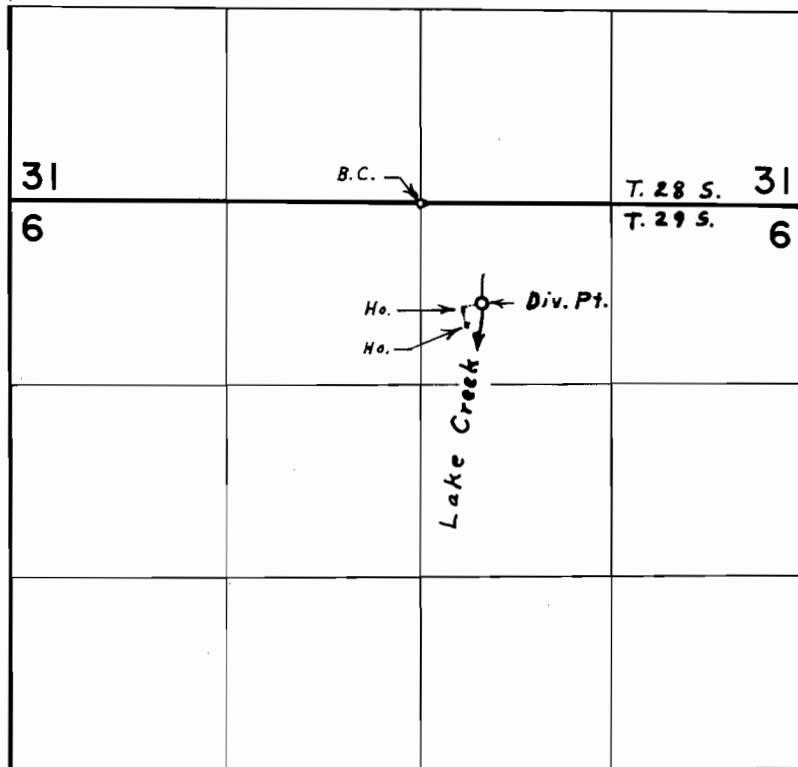

Div. Pt. located 690' S. & 420' E. from N. $\frac{1}{4}$ Cor. Sec. 6

FINAL PROOF SURVEY UNDER

Application No. 53237... Permit No. 39507...
IN NAME OF

MICHAEL JOSEPH McCULLOCH

Surveyed May 25, 1975, by L. E. Gould...