

SCALE: 1" = 100'

○ PND I. P.  
● SET I. P.

McKENZIE RIVER

S 34° 02' 15" W 127.00'  
S 74° 08' 55" W 162.27'  
S 69° 22' 40" W 289.26'  
S 69° 22' 40" E 270.27'  
N 74° 08' 55" E 271.29'  
N 84° 02' 15" E 98.29'

50' EASEMENT

TEST WELL  
WELL SITE #1

WELL SITE #2

SEE LOC of well #1  
ON MAP FOR  
APPL. 5-295

15' EASEMENT  
S 0° 52' W 187.79'  
N 0° 52' E 187.79'

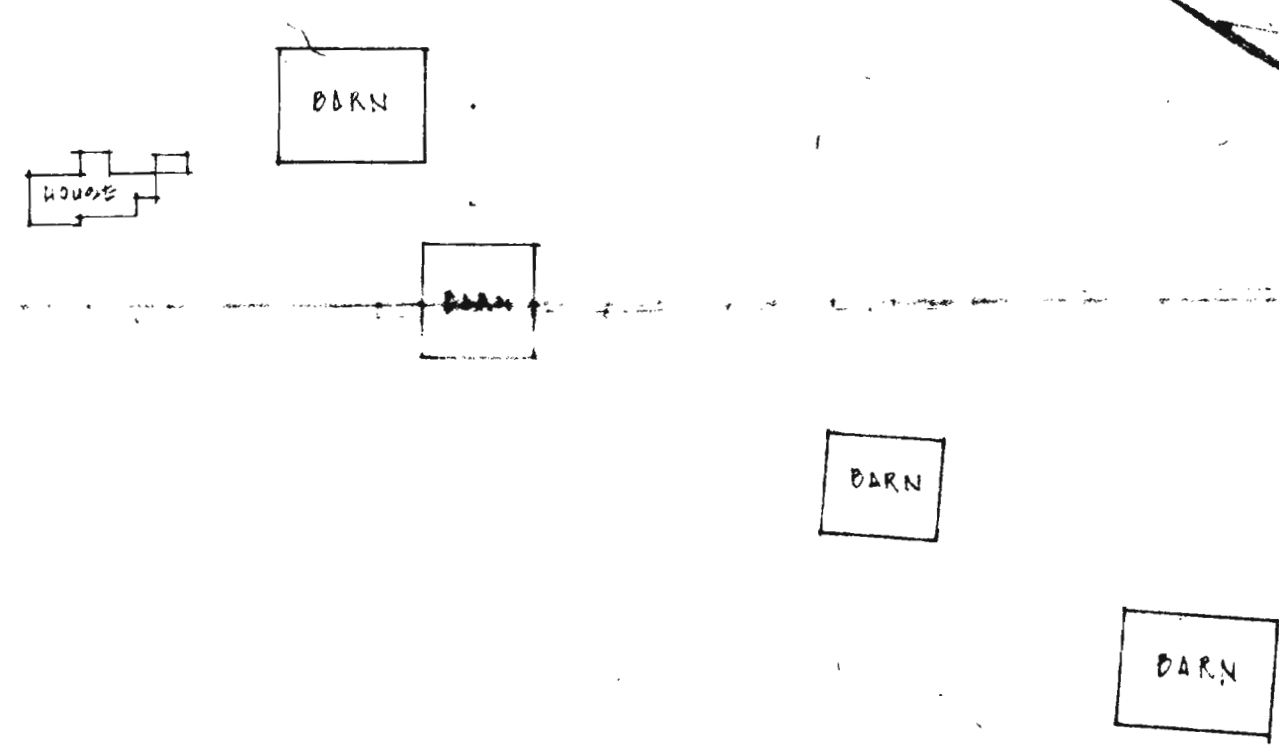

FOUND 2" IRON PIPE  
FUTURE ADDITION TO NORTHWOOD ESTATES

EASEMENT SURVEY FOR  
RAINBOW WATER DISTRICT

PORTION OF CHESTER CRASE PROPERTY  
SEC 29, T17S, R2W, WIL. MERIDIAN  
LANE COUNTY OREGON  
WESTERN ENGINEERING CONSULTANTS  
1445 WILLAMETTE EUGENE, OREGON  
DRAWN: LL DATE 11-17-64 JOB NO: 9080 TUBE:

HAYDEN BRIDGE ROAD

FD. PK. MARK  
SECTION CORNER

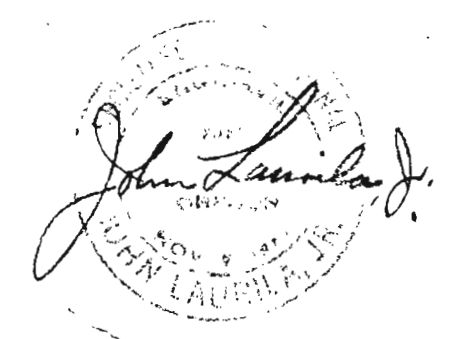

Application No. G-3000  
Permit No. G-2995