

RECEIVED

SEP 12 1969

STATE ENGINEER
SALLM. OREGON

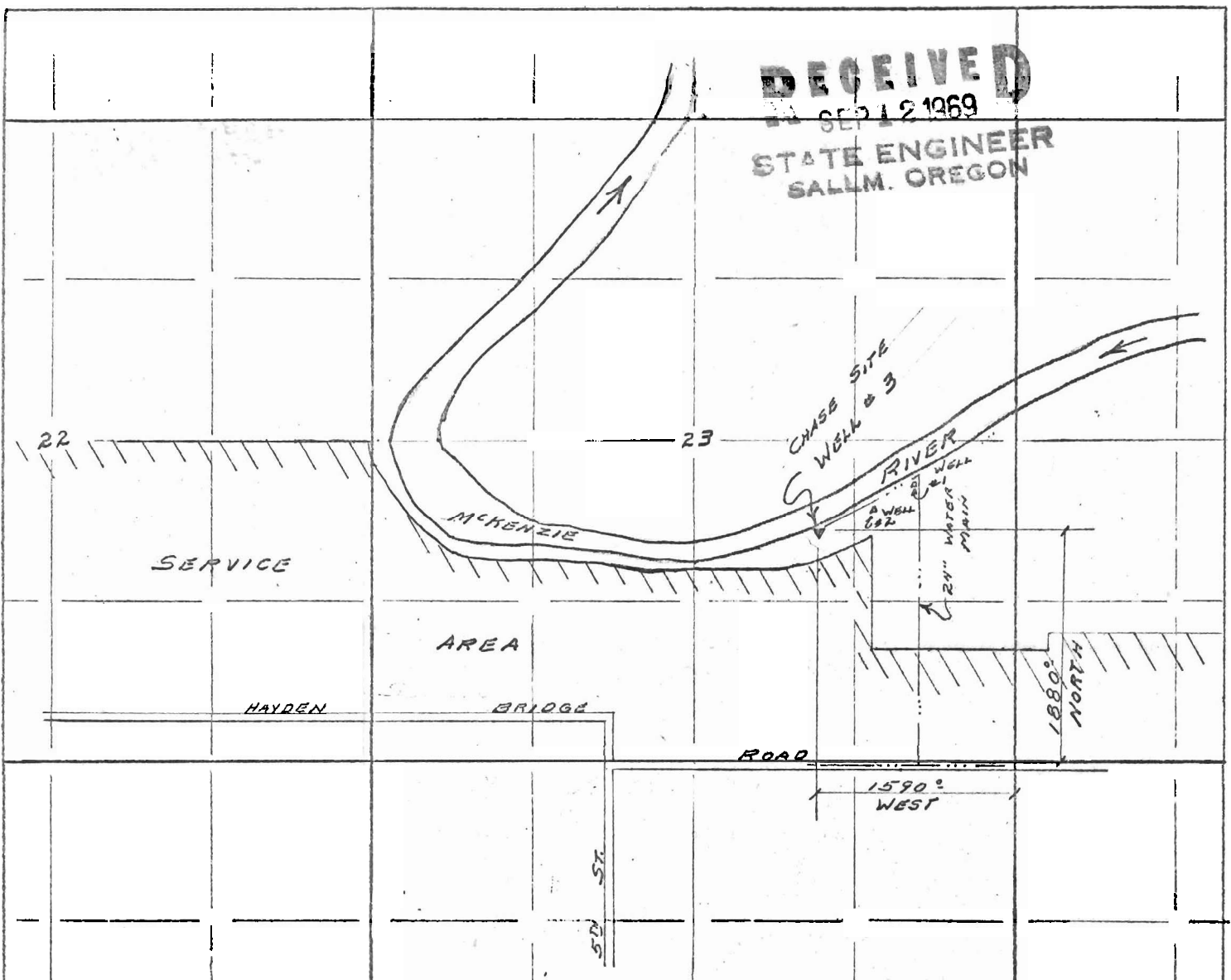

Application No. G4991
Permit No. G 4709

CHASE SITE
WELL # 3
to

RAINBOW WATER DISTRICT
SEC 23, T 17S, R 3 W, W.M.
SPRINGFIELD, LANE COUNTY
OREGON



Scale
1" = 1 mile

