

T.6S. R.5W. W.M.

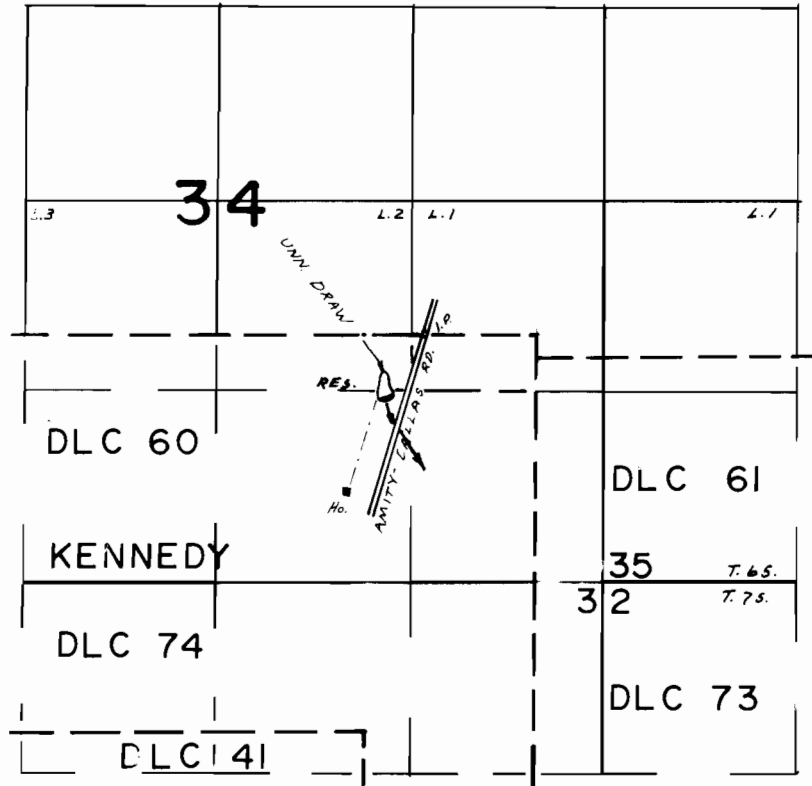

DAM LOC. 430'S & 1020' W FROM NE COR. KENNEDY DLC 60

FINAL PROOF SURVEY UNDER

R-47286 R-5696
 Application No. 47287 Permit No. 35431
 IN NAME OF

HARLEY DAVISON

Surveyed APR. 15 1975, by L.H. NUNN