

T5N. R.35&36E. W.M.

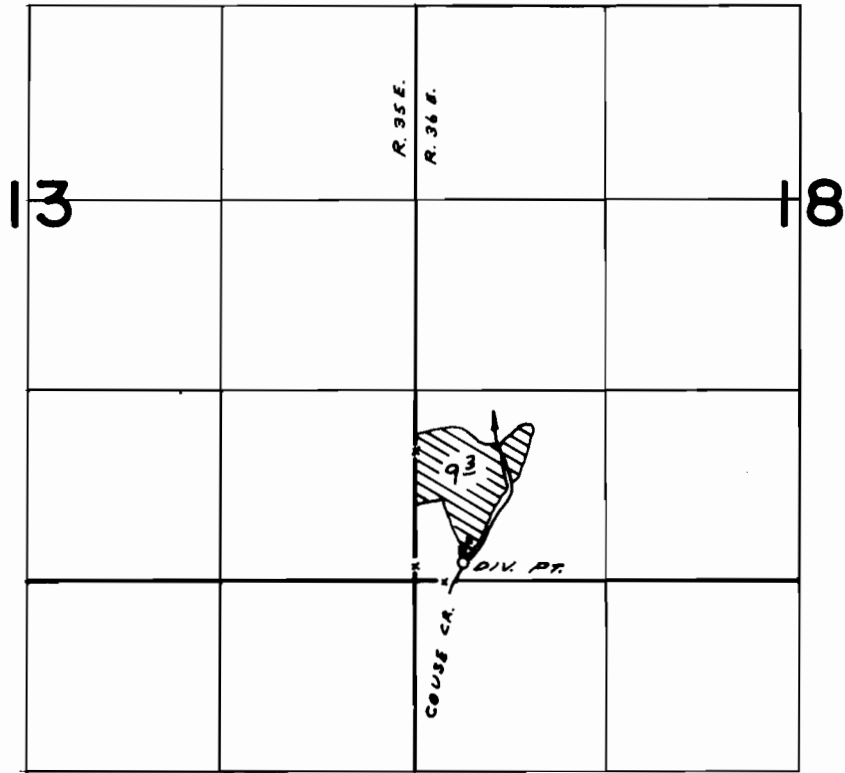

DIV. PT. LOG. 130' N. & 330' E FROM SW COR. SEC. 18

**FINAL PROOF SURVEY**  
UNDER

Application No. 47.67.0... Permit No. 35667...  
IN NAME OF

..... LYLE MORRIS .....

Surveyed APR. 3... 1975, by L.H. NUNN .....