

T.5S.R.1E.&I.W.W.M.

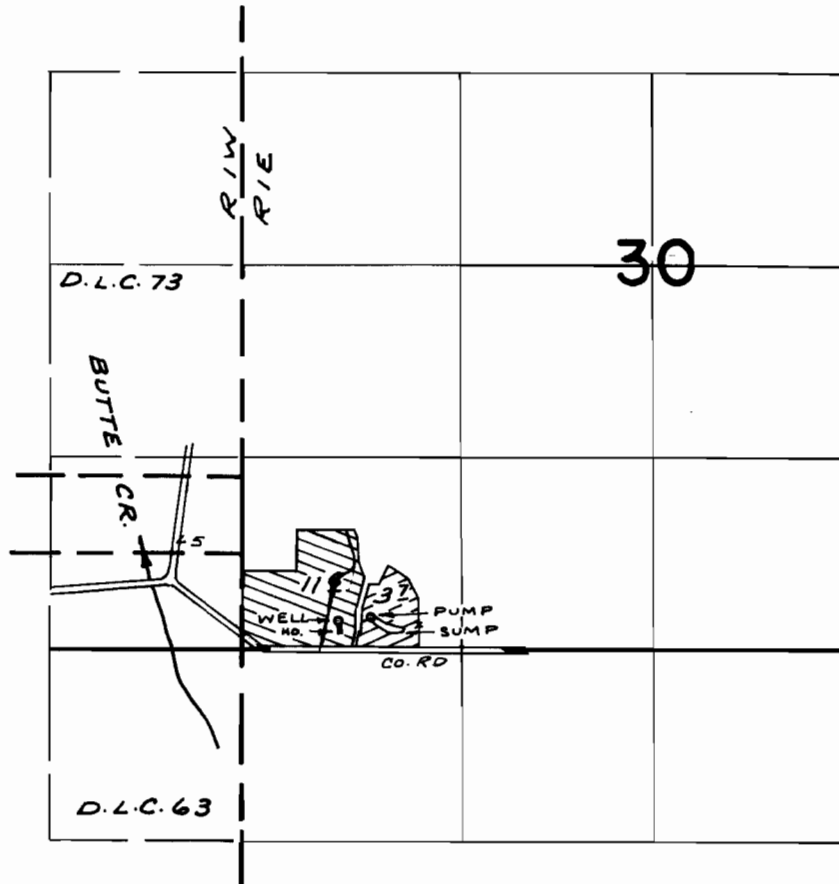

DIV. PTS. LOC: WELL - 200' N & 660' E ; SUMP - 220' N & 880' E , BOTH FROM S.W. COR. SEC. 30

FINAL PROOF SURVEY UNDER

Application No. G-4770 Permit No. G-4501
IN NAME OF

WM. J. DAHLSEID

Surveyed JULY 3, 1973, by R. MUCKEN