

T.38S.,R.3W.,W.M.

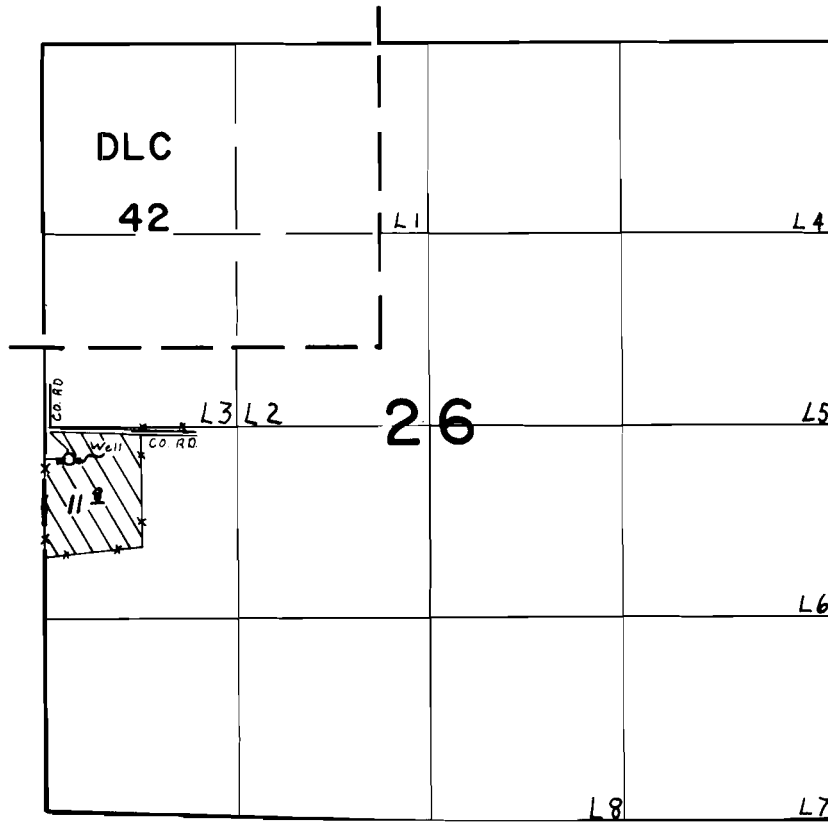

WELL: 210'S & 150'E FROM THE W 1/4 COR SEC. 26

FINAL PROOF SURVEY
UNDER

Application No. G-5084 Permit No. G-4799
IN NAME OF

DAVID P. JOHNSON

Surveyed MAY 6 1976, by C.R. KING