

T.14S. R.5W. W.M.

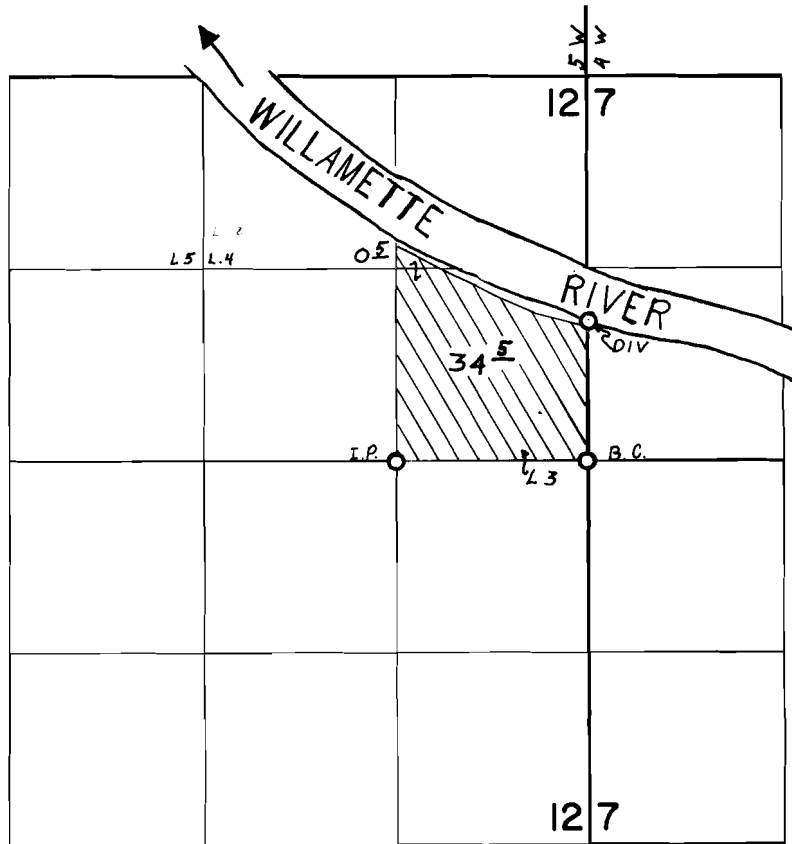

DIV: 940' N OF E 1/4 COR. SEC 12

**FINAL PROOF SURVEY**  
UNDER

Application No. 50328... Permit No. 37996...  
IN NAME OF

**CROCKER BROTHERS FARMS**.....

Surveyed APR. 20. 1976., by C.R. KING.....