

# T.4S. R.4E. W.M.

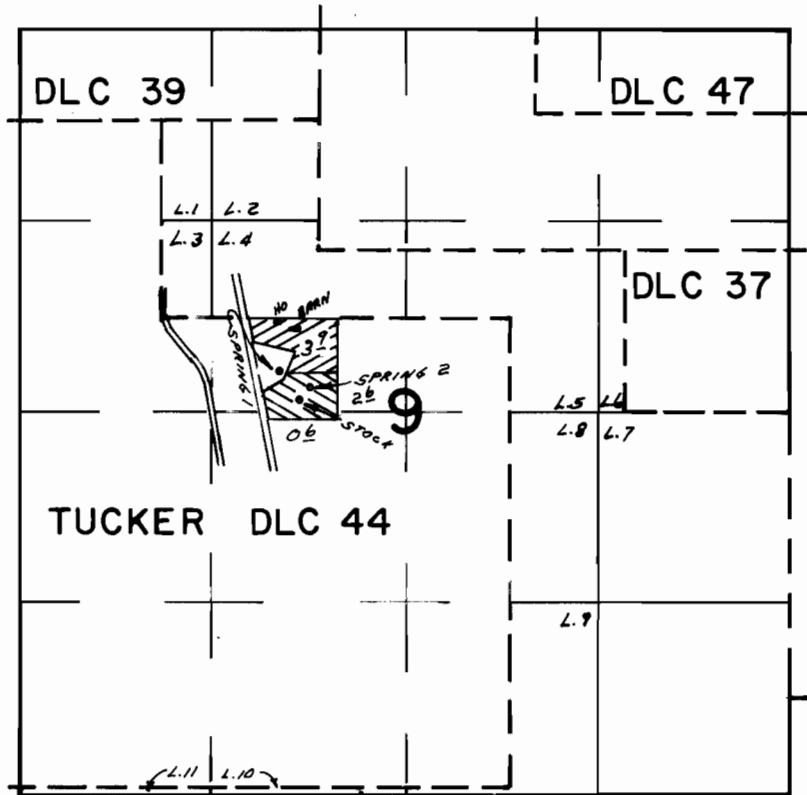

SPRING 1 - 370'S. & 800'E.; SPRING 2 - 470'S. & 1010'E. FROM THE SW COR. LOT 3

 → SPRING #1    
  → SPRING #2

## FINAL PROOF SURVEY UNDER

Application No. 47451    Permit No. 35942  
IN NAME OF

GAYLORD S. & SARAH C. EGGLESTON

Surveyed AUG. 16. 1976, by L.E. GOULD