

T.4 S. R.3 E. W.M.

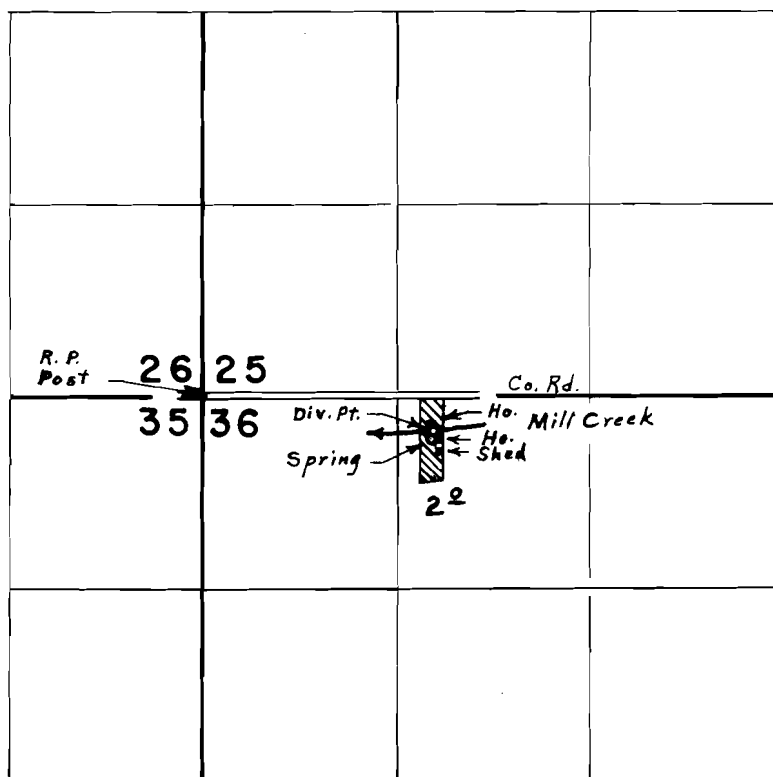

Div. Pts. located: Spring, 300' S. & 1570' E.; Stream, 250' S. & 1580' E., both from N. W. Cor. Sec. 36

FINAL PROOF SURVEY UNDER

Application No. 47719 Permit No. 35746
IN NAME OF

HERBERT L. PANKRATZ

Surveyed April 20, 1976, by L. E. Gould