

T.28S., R.5W., W.M.

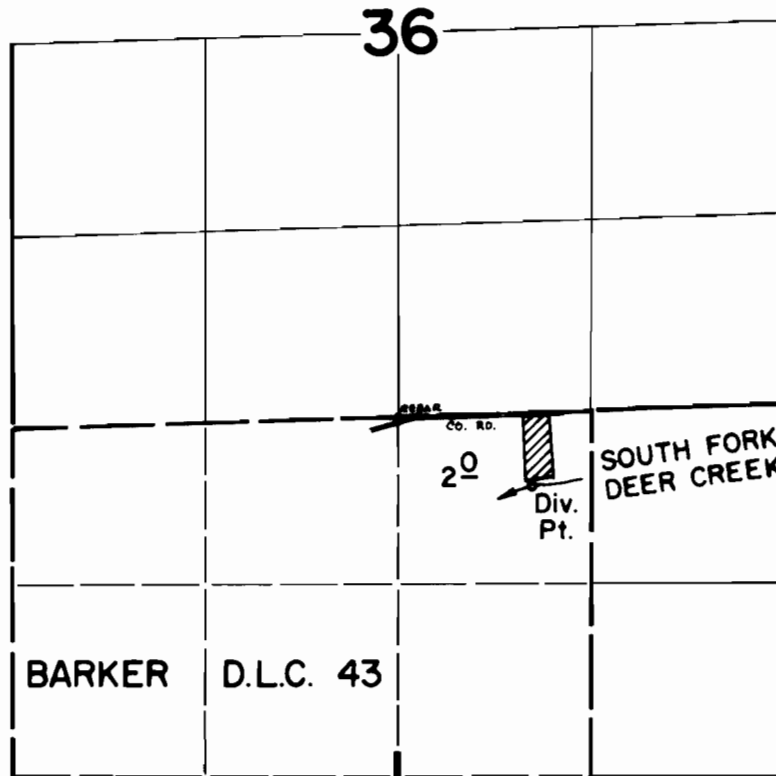

DIV. PT. LOC: 500' S & 910' E FROM N 1/4 COR. SEC. 1

**FINAL PROOF SURVEY**  
UNDER

Application No. 49452 Permit No. 37045  
IN NAME OF

HARLAND C. DeSPAIN

Surveyed April 5 1976, by D. Norby