

T.29S. R.7 W. W.M.

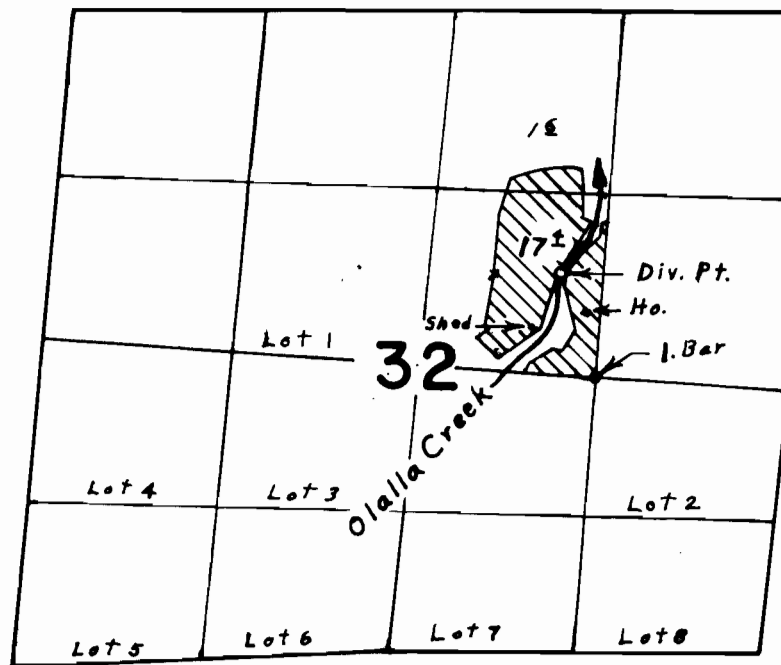

Div. Pt. loc. 710' N. & 230' W. from S. E. Cor. S.W. 1/4 N.E. 1/4 S. 32

**FINAL PROOF SURVEY**  
UNDER

Application No. 50716... Permit No. 38306.  
IN NAME OF

CARL EHLER

Surveyed May 26, 1976, by L. E. Gould.