

T.30S. R.4W. W.M.

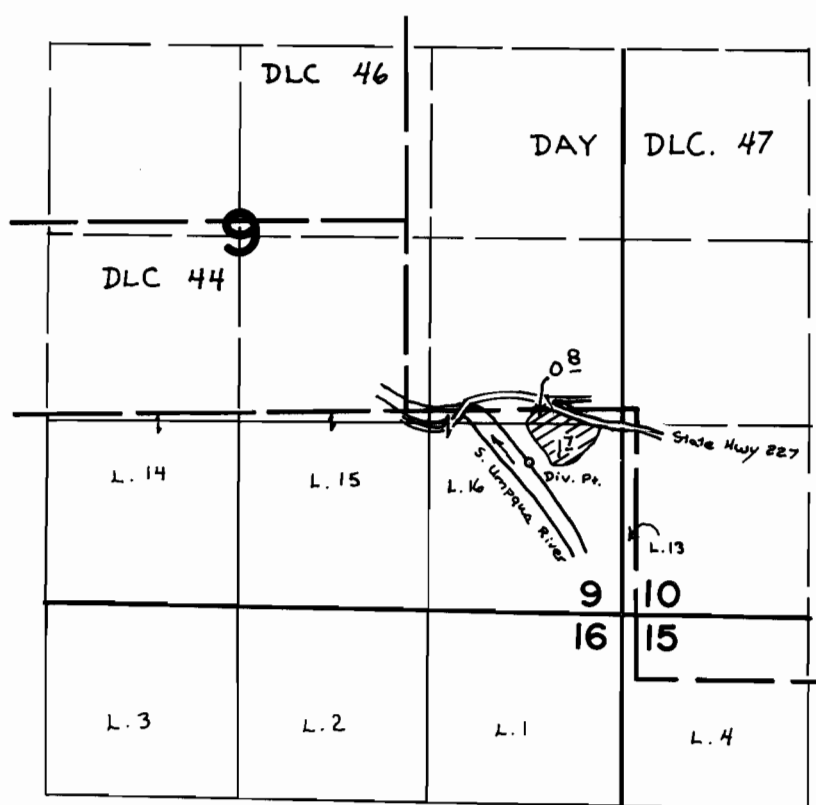

Div. Pt. Located 1025' N & 650' W from SE cor Sec. 9

FINAL PROOF SURVEY UNDER

Application No. 51037 Permit No. 38518
IN NAME OF

THOMAS A. & FLORENCE J. MURPHY

Surveyed MAY 11, 1976, by L. E. GOULD