

T.38S.,R.4W.,W.M.

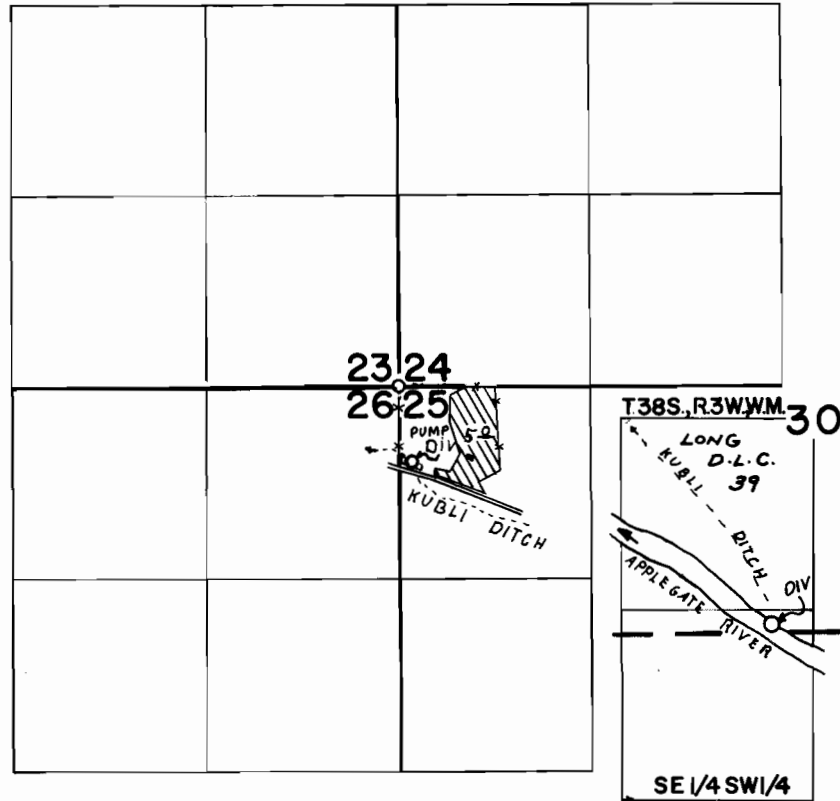

DIV: 2510'S & 3370'W FROM THE NE. COR GEORGE LONG D.L.C. 39 IN SEC 30 T38S.,R.3W.,W.M.

FINAL PROOF SURVEY
UNDER

Application No. 52333 Permit No. 39359
IN NAME OF

E. W. KUBLI

Surveyed APR. 30. 1976., by C.R. KING