

T.17 S. R.10 W. W.M.

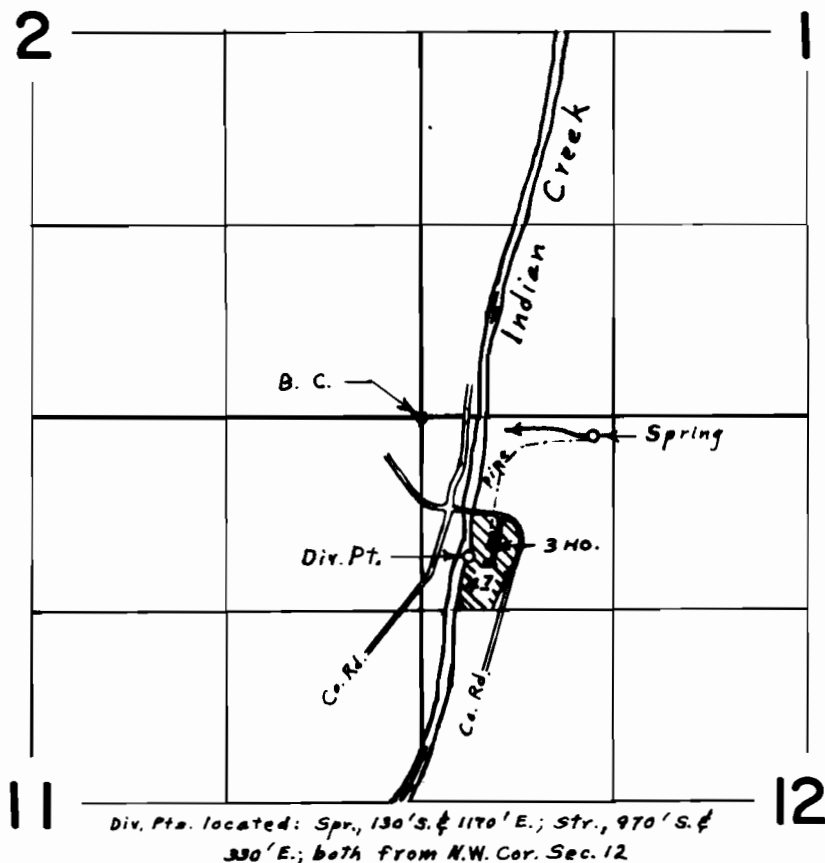

Div. Pts. located: Spr., 130' S. & 1170' E.; Str., 970' S. & 330' E.; both from N.W. Cor. Sec. 12

FINAL PROOF SURVEY
UNDER

Application No. 45208.. Permit No. 33773..
IN NAME OF

THOMAS R. OR MARION S. BEERS

Surveyed Aug. 5., 1976., by L. E. Gould.