

T.6S.,R.10W.,W.M.

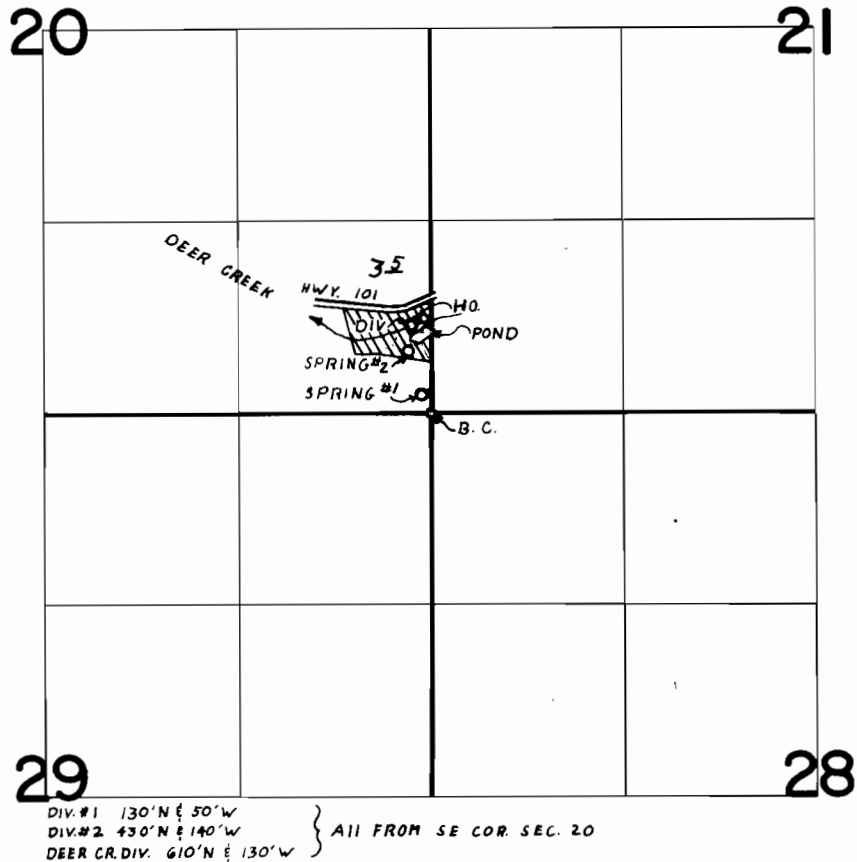

DIV.#1 130'N E 50'W
DIV.#2 430'N E 140'W
DEER CR.DIV. 610'N E 130'W } ALL FROM SE COR. SEC. 20

FINAL PROOF SURVEY
UNDER

Application No. 42611 Permit No. 31244
IN NAME OF
C. E. MULLINS

Surveyed JUNE 30, 1976., by C.R. KING