

T.18S. R.45E. W.M.

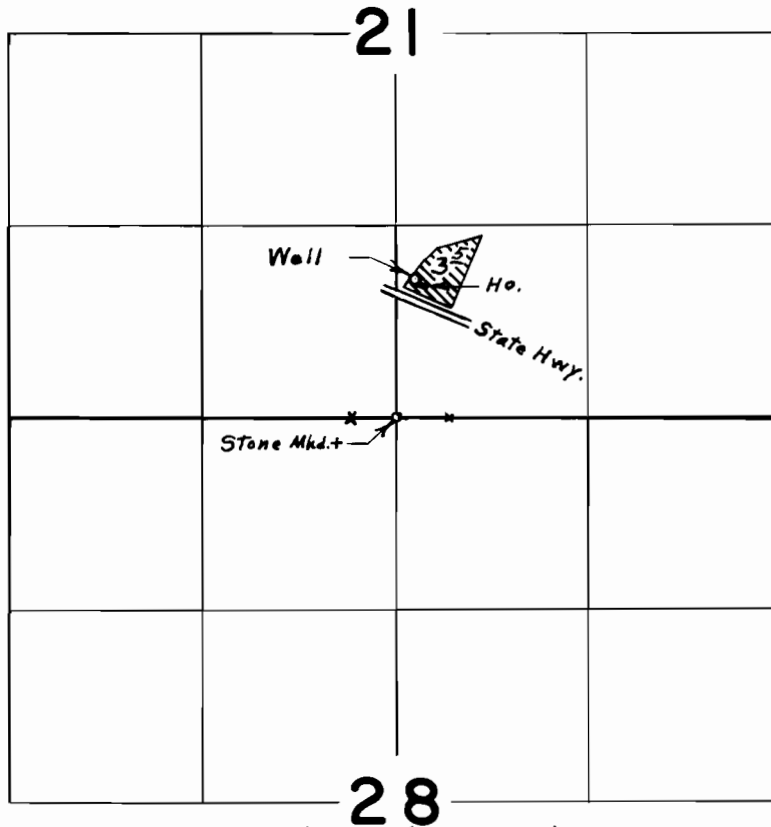

Well located 950' N. & 130' E. from S. $\frac{1}{4}$ Cor. Sec. 21

FINAL PROOF SURVEY
UNDER

Application No. G-6533. Permit No. G-6141...
IN NAME OF

LINDY DENTINGER

Surveyed May 5, 1976, by L. E. Gould.